

# CERTIFICATE OF LOCATION OF GOVERNMENT CORNER

NORTH 1/4 Corner of Section 21, Township 30, Range 22, \_\_\_\_\_ P.M.

STATE OF MINNESOTA, County of RAMSEY

At the corner location shown on the sketch:

On FEB 1967 found a PK NAIL IN CONST JOINT  
DATE

left monument as found,  lowered monument,  removed monument (explain)

On AUG 1969 placed a M.H.D CAST IRON MONUMENT - M.H.D.  
DATE

## SKETCH OF REFERENCE TIES

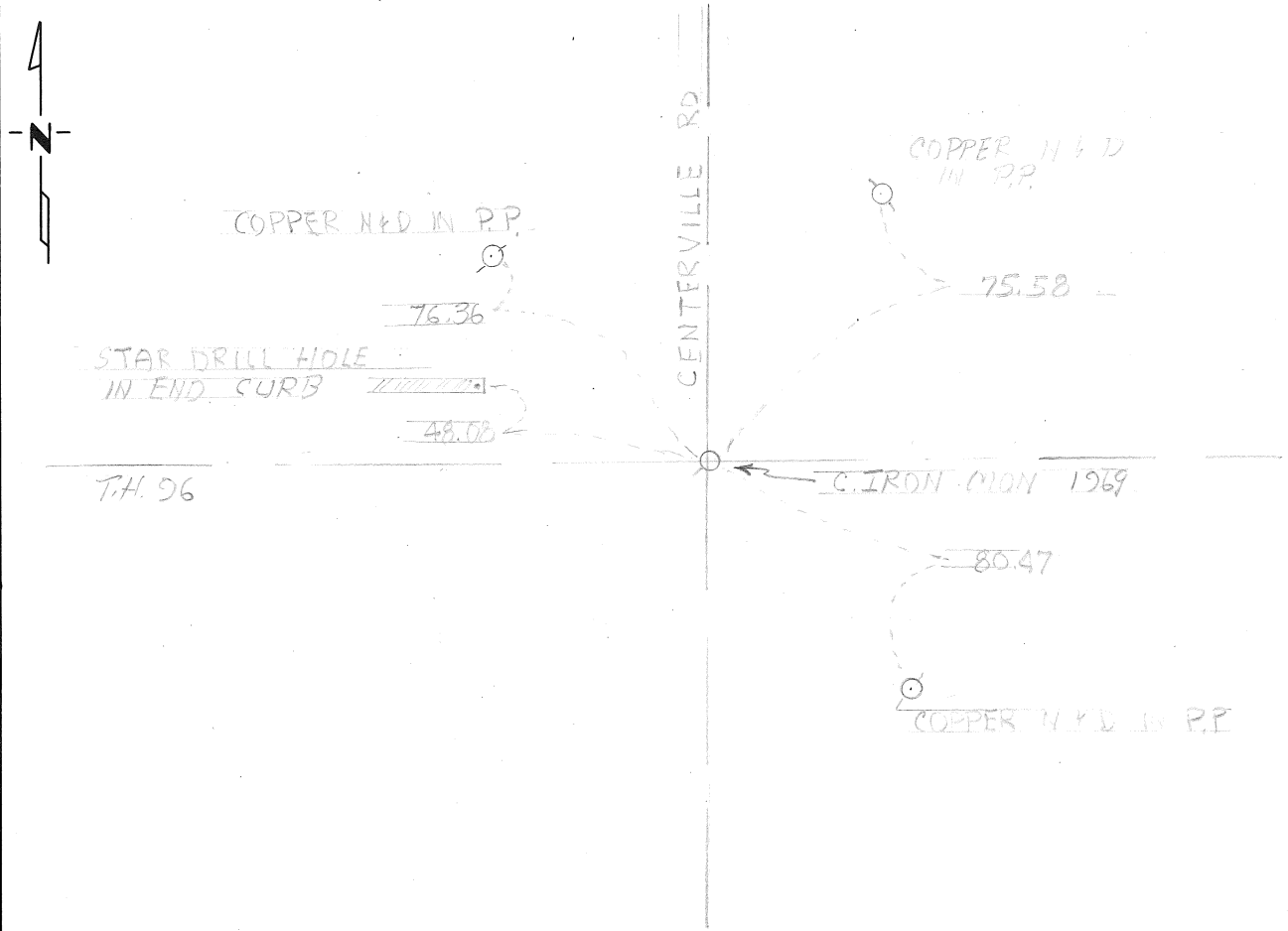

Statement of evidence relative to this corner location is on back of page.

I hereby certify that this document and the data contained herein was prepared by me or under my direct supervision.

\_\_\_\_\_  
SIGNATURE DATE

Registration No. \_\_\_\_\_

- Land Surveyor,  Professional Engineer
- County Surveyor,  County Engineer

OFFICE OF THE REGISTER OF DEEDS

County of \_\_\_\_\_

I hereby certify that this document was filed in the Reg. of Deeds office at \_\_\_\_\_ .M. on the \_\_\_\_\_ day of \_\_\_\_\_ A.D., 19 \_\_\_\_\_

Register of Deeds \_\_\_\_\_

By \_\_\_\_\_, Deputy

DOCUMENT NO. \_\_\_\_\_

Statement of Evidence:

FEB 1967 T.H. 96 S.P. 6224-17 NOTES BY SHALDON FOY  
FOUND A RK NAIL IN A CAST JOINT. NOTES T.H. 35 E S.P. 6281  
PLACED M.H.D. CAST IRON MONUMENT AUG 1969 BY DAVE PEARSON  
ALSO THRU NEW TIPS BOOK B1 CONTROL No. 13671  
S.P. 6280-36 S.P. 6281-04 S.P. 6285-61 (T.H. 35 E-390)