

CERTIFICATE OF LOCATION OF GOVERNMENT CORNER

W¹/₄ Corner of Section 6, Township 30, Range 21, 4th P.M.

STATE OF MINNESOTA, County of Washington

At the corner location shown on the sketch:

- On _____ found a _____
DATE
- left monument as found, lowered monument, removed monument (explain)
- On 5-03-1978 ~~position~~ Position falls in swamp and no monument was set at this time. See back.
DATE
REVISED 6-20-80 PDA

SKETCH OF REFERENCE TIES

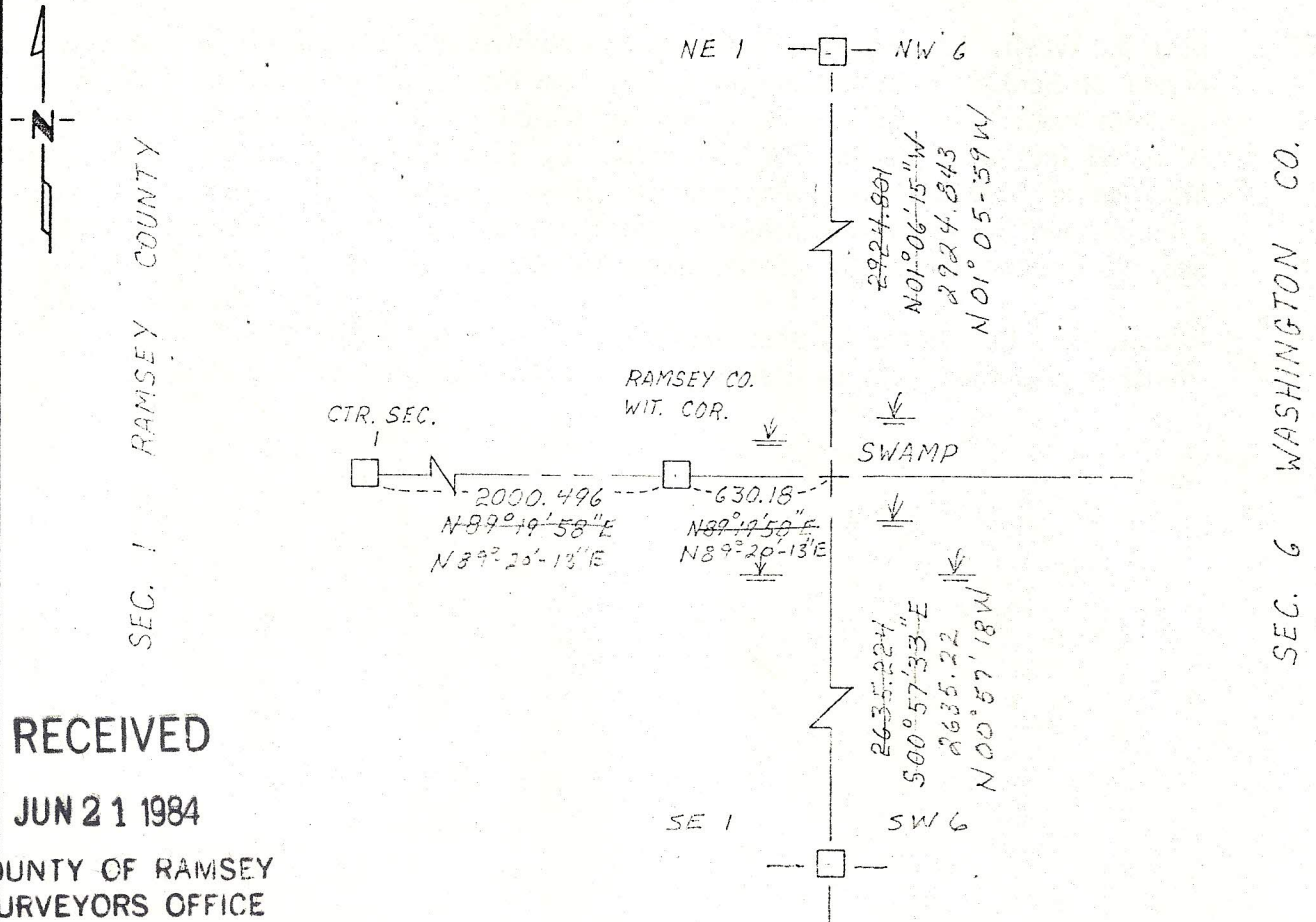

RECEIVED

JUN 21 1984

COUNTY OF RAMSEY
SURVEYORS OFFICE

Statement of evidence relative to this corner location is on back of page.

I hereby certify that this document and the data contained herein was prepared by me or under my direct supervision.

Paul A. Johnson 7/7/78
SIGNATURE DATE

Registration No. 10938

- Land Surveyor, Professional Engineer
- County Surveyor, County Engineer

OFFICE OF THE REGISTER OF DEEDS
County of _____

I hereby certify that this document was filed in the Reg. of Deeds office at _____ .M. on the _____ day of _____ A.D., 19 _____

Register of Deeds _____

By _____, Deputy

DOCUMENT NO. _____

MEY
FEB 1 1984

Statement of Evidence:

Quarter corner common to Section 1, T30 R22 and Section 6, T30 R21.

- 1847 Original government surveyors set post and recorded one bearing tree:
Wht. Oak 20" S 30° W 15.90 ch.
- 1910 April 5 & 6, J.M. Oldham in fieldbook 6, page 29, records a subdivision survey of Section 6, but no monumentation shown at this corner.
- 1977 November 1, Frank Kvidera, Reg. No. 6469, notified Wash. Co. Surveyor's Office that Ramsey County has a witness monument 630.18 feet west of this corner.
- 1978 May 3, Wash. Co. Surveyor's Office re-established the position for the W¼ corner of Section 6 by projecting a line from the center of Sec. 1, T30 R22 (Granite mont.) through a Witness Corner (Granite mont. recorded to be 630.18 feet west of the E¼ Cor. Sec. 1, T30 R22) and measuring a distance of 630.18 feet east from the witness corner. This position is substantiated by comparing present dimensions with those on record in Ramsey and Washington Counties. Coordinates for this corner are: Yp 63958.602
Xp 662319.153
(Wash. Co. Coordinate System South Zone, February 1977 Adj.)
Position of corner falls in a swamp and no monument set at this time.

1980 June 20, revised W¼ cor coordinate based upon new
Least Squares adj. Yp = 154959.466
Xp = 662318.831 Pof

RECEIVED

JUN 21 1980

COURT OF RAMSEY COUNTY
SURVEYORS OFFICE