

CERTIFICATE OF LOCATION OF GOVERNMENT CORNER

Center Corner to Section 18 Township 29 N. Range 22 W. No. _____

STATE OF MINNESOTA,

County of Ramsey S.S.

I hereby certify that on the 19th day of June 1962,

that I, Charles O. Georgi, a Registered Land Surveyor, ~~County Surveyor,~~

~~County Highway Engineer,~~ ^{reset} found the center corner of Section 18, T 29N, R 22W.

which was evidenced by old ties

and I further certify that to perpetuate the

location of such corner I did, at the exact location thereof, place a permanent marker

consisting of cast iron monument.

I further certify that I established 5 references or witness monuments consist-

ing of ties to 2 House Foundations, 2 Power Poles and a guard post which reference or witness monuments are

located in the manner following.

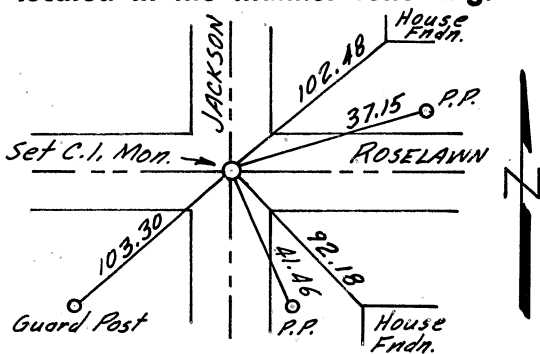

- SW 103.30 Guard Post
 - SSE 41.46 Power Pole
 - ENE 37.15 Power Pole
 - NE 102.48 SW Cor. House Foundation
 - SE 92.18 NW Cor. House Foundation
- (C.I.M. flush with blacktop pave in center of intersection.)

Dated at St. Paul, Minnesota, this 2nd day of August, 1962.

Charles O. Georgi
~~County Surveyor, County Highway Engineer,~~
 Registered Land Surveyor No. 3960

OFFICE OF THE REGISTER OF DEEDS

County of _____

I hereby certify that the within instrument was filed in this office for record on the

_____ day of _____ A.D., 19____.

Register of Deeds

By _____, Deputy