

2635.0
 2639.05
 5274.05

SEC 23

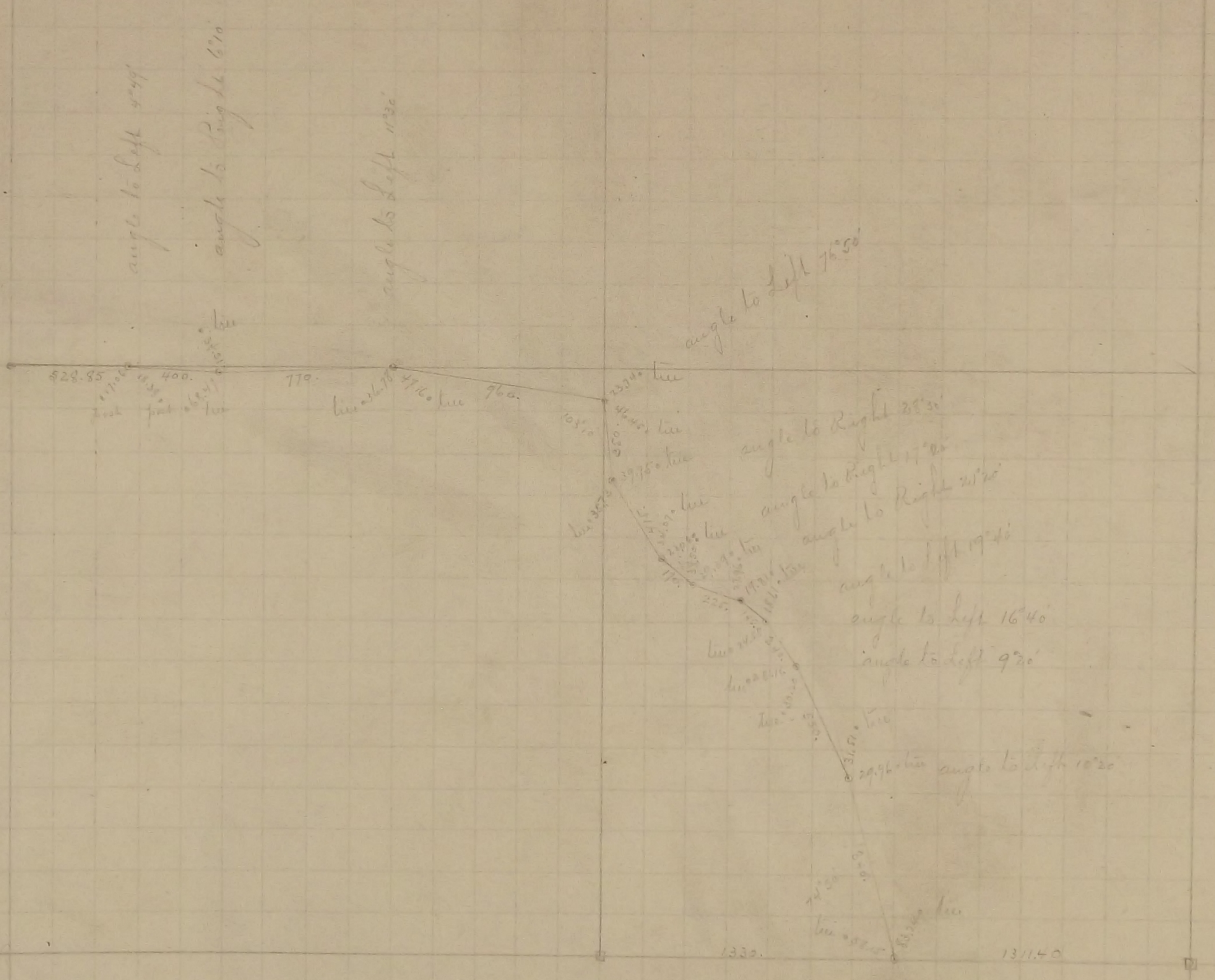

Fixed the Center of Section 23 by Intersection

March 3 - 1899
Set Mount Dec. 1899

Made Survey of Road through Section 23 December 17th - 1896 See page 95

In Establishing the North West Corner of Section 23 Found our Gov. witness stump and also found stake at Section Corner Retired it in May - 1896 Set Mount May 28 - '97

In Establishing the $\frac{1}{4}$ Corner between Sections 22 and 23 Found our Gov. witness stump and fixed corner which checks the line of fence running West. Retired it and fixed corner Dec. 8 - 1896 Set Mount May 28 - 1897

In Establishing the South West Corner of Section 23 Measured North from $\frac{1}{4}$ Corner found between Sections 26 & 27 2640 ft. found old stake Gov. witness tree gone Fixed corner Retired it and set Mount Oct. 1895

In Establishing the $\frac{1}{4}$ Corner between Section 23 and 26 Found old stake at $\frac{1}{4}$ Corner Gov. witness tree gone Retired corner Nov. 4 - 1895 and set Mount.

In Establishing the South East Corner of Section 23 - Measured East from Mount at $\frac{1}{4}$ Corner between Section 23 and 26 - 2641.40 which appeared to be about correct according to all evidence Gov. witness tree gone Fixed corner Dec. 5 - 1896
Retired it and set Mount

The $\frac{1}{4}$ Corner between Section 14 and 23 was fixed at half way between Section Corner Gov. witness tree gone Set Mount Oct. 28 - 1897

The North East Corner of Section 23 was fixed by using Government distance from Meander Corner No. 9 Gov. witness tree gone Set Mount Oct. 28 - 1897

Meander Corner No 9 was fixed from Gov. witness tree Set Mount Oct. 28 - 1897

Meander Corner No 10 was fixed by using Gov. distance from Section Corner Gov. witness tree gone Set Mount Oct. 28 - 1897

Fixed $\frac{1}{4}$ Corner between Sections 23 and 24 Jan 28 - 1898 in Snail Lake.