

SEC 23

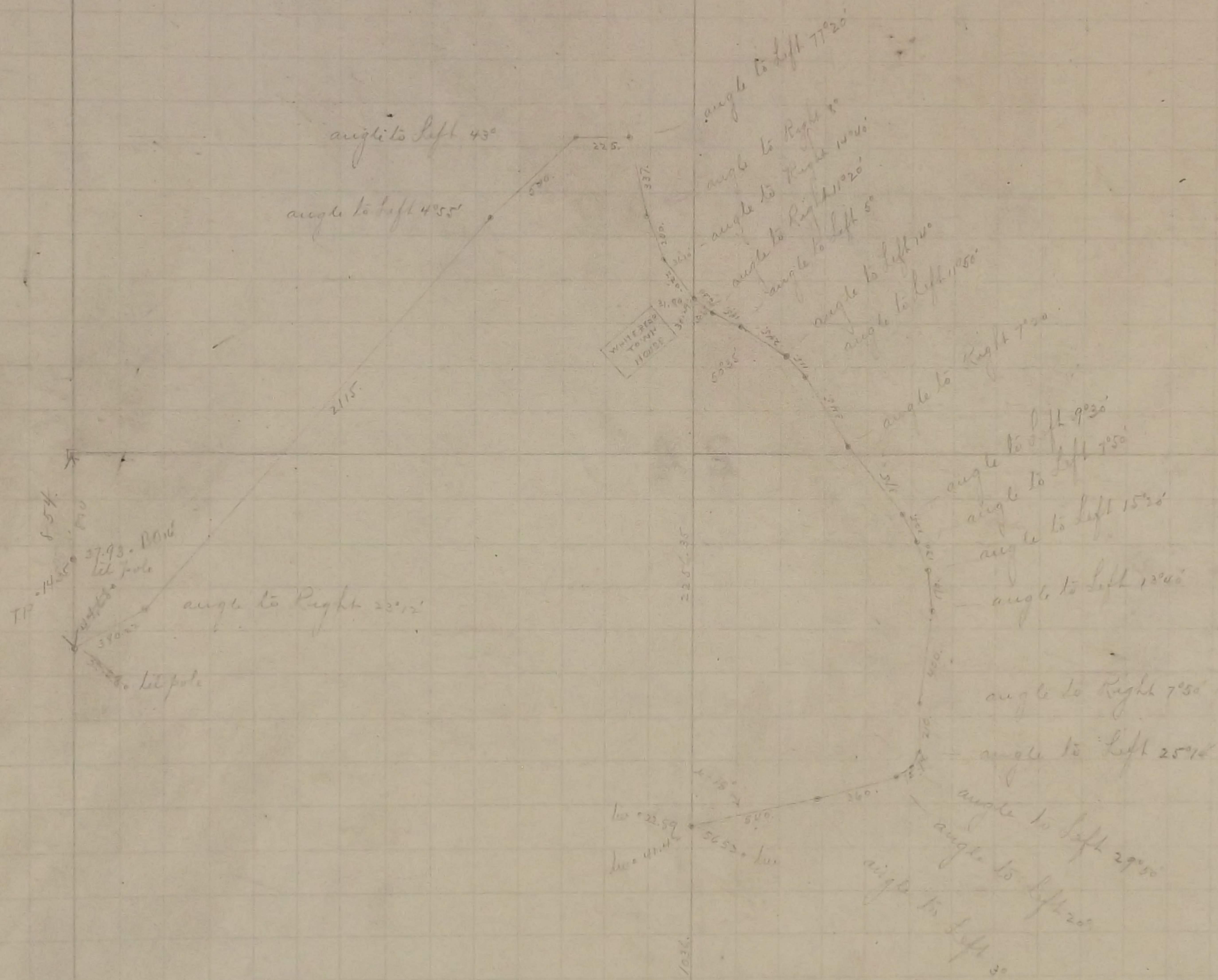

Made Survey of Road in Section 23 Aug. 1896 see page 95

In Establishing the $\frac{1}{4}$ Corner between Sections 23 and 26 found old stake no witness trees
and set Monument Retied it Aug 29 - 1896

Found old Pamarrack stake at $\frac{1}{4}$ Corner between Sections 22 and 23 found two Government witness stumps
Retied it Oct 6 - 1896 Set Mont.

In Establishing the South West Corner of Section 23 Ran East from $\frac{1}{4}$ Corner between Sections 22 and 27
Government distance Government witness trees gone Feb. 1900
Set Mont

In Establishing the $\frac{1}{4}$ Corner between Sections 14 and 23 found old Boulder Monument
tied by Gates A. Johnson Jr. in May 1886

In Establishing the South East Corners of Section 23 This corner was fixed from
the line of old fence Government witness trees gone
Set Mont. July 20 - 1898

In Establishing the N. W. corner of Section 23 found old stake at Section
corner which was fixed when Government trees were standing tied it
and set Monument June 1900

In Establishing Meander corner No. 4 Found one Government witness tree and one
Government stump fixed corner Jan. 15 - 1902 Set Mont. Dec. 3. 1902

In Establishing Meander corner No. 5 Ran North from S.E. corner of Section 23
along line of old fence pro-rated and fixed Meander corner No Government
trees Jan. 14. - 1902 Set Mont. Dec. 3. - 1902

Fixed the center of Section 23 by Intersection Jan. 15 - 1902
Set 3 Monts. at tied at points on shore of Goose Lake Dec. 1 - 1902