

MONUMENT 482

CERTIFICATE OF LOCATION OF GOVERNMENT CORNER

East Quarter corner of Section 22, Township 29 North, Range 22 West, County of Ramsey, State of Minnesota.

At the corner location shown on the sketch

On October 14, 2015 found a cast iron monument over a granite monument.

left monument as found raised/lowered monument removed monument (explain)

On October 14, 2015 removed cast iron monument; Cast iron manhole assembly set over granite monument by others.

SKETCH OF REFERENCE TIES

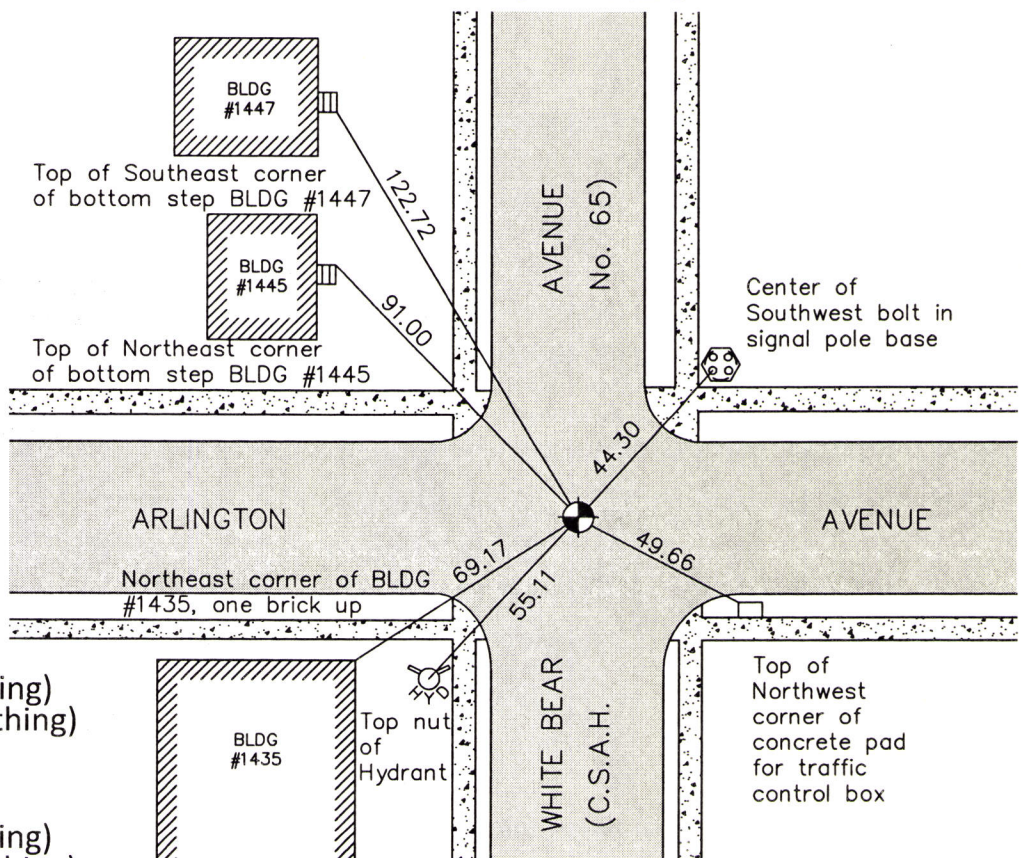

MONUMENT 482

RAMSEY COUNTY
NAD83 (1986)
X= 592663.379 (Easting)
Y= 170796.684 (Northing)

RAMSEY COUNTY
NAD83 (2011)
X= 592663.061 (Easting)
Y= 170797.315 (Northing)

ALL DISTANCES ARE SHOWN IN U.S. SURVEY FEET.

Statements of evidence relative to this corner are on the following page.

I hereby certify that this survey, plan, or report was prepared by me or under my direct supervision, that I am a duly Licensed Land Surveyor under the laws of the state of Minnesota, and that this certificate is correct and complete to the best of my knowledge and belief.

Daniel D. Baar 6-7-16
Date
Daniel D. Baar
Deputy County Surveyor
Minnesota License No. 45816

OFFICE OF COUNTY SURVEYOR
County of Ramsey

I hereby certify that this document was filed in the County Surveyor's office this 7th day of June, 2016.

Craig W. Hinzman
Craig W. Hinzman, L.S.
Ramsey County Surveyor

MONUMENT 482

East Quarter Corner of Section 22, Township 29 North, Range 22 West

November 29, 1847	Set Quarter Section post; Bur Oak 12 S64°W 15, Bur Oak 15 S50°E 88. Isaac Higbee, Deputy Surveyor
March 27, 1890	Monument set my J.H. Armstrong. City of St. Paul Surveyor's Office
April 26, 1972	Re-grouted Granite Monument. City of St. Paul Surveyor's Office
July, 1982	Placed ties on PK nail. City of St. Paul Surveyor's Office
February, 1988	Iron pin set to grade. City of St. Paul Surveyor's Office
March 2, 1988	Traversed through iron pin. City of St. Paul Surveyor's Office
November 17, 1995	Recovered Iron Pin in Granite Monument. Granite Monument down 0.5ft below grade. Removed pin and retied monument. City of St. Paul Surveyor's Office
December 27, 1995	Certificate of Location signed by Richard Person. City of St. Paul Surveyor's Office
December 21, 1998	Found Granite Monument 0.5ft below grade. From 4 PK straddles, set 0.5ft tall Cast Iron Monument over Granite Monument using straddles. City of St. Paul Surveyor's Office
December 23, 1998	Certificate of Location signed by Jeffrey Grosso. City of St. Paul Surveyor's Office
March 17, 2000	Found Cast Iron Monument at grade. Marked as aerial target for spring aerial photo flight. City of St. Paul Surveyor's Office
November 28, 2001	Used Cast Iron Monument for traverse. City of St. Paul Surveyor's Office
October 31, 2012	Found Cast Iron Monument at street grade. Photos taken. City of St. Paul Surveyor's Office
May 22, 2015	Found Cast Iron Monument at street grade. Tied for removal during road reconstruction. Ramsey County Surveyor's Office.
October 14, 2015	Found Granite Monument underneath Cast Iron Monument. Removed Cast Iron Monument and left Granite Monument as found and retied. Cast iron manhole assembly set by others. Ramsey County Surveyor's Office