

MONUMENT 158

CERTIFICATE OF LOCATION OF GOVERNMENT CORNER

North Quarter Corner of Section 22, Township 30 North, Range 23 West, County of Ramsey, State of Minnesota.

At the corner location shown on the sketch

On July 29, 2010 found a cast iron monument, within a cast iron manhole assembly.

left monument as found raised/lowered monument removed monument (explain)

On _____ placed a _____

SKETCH OF REFERENCE TIES

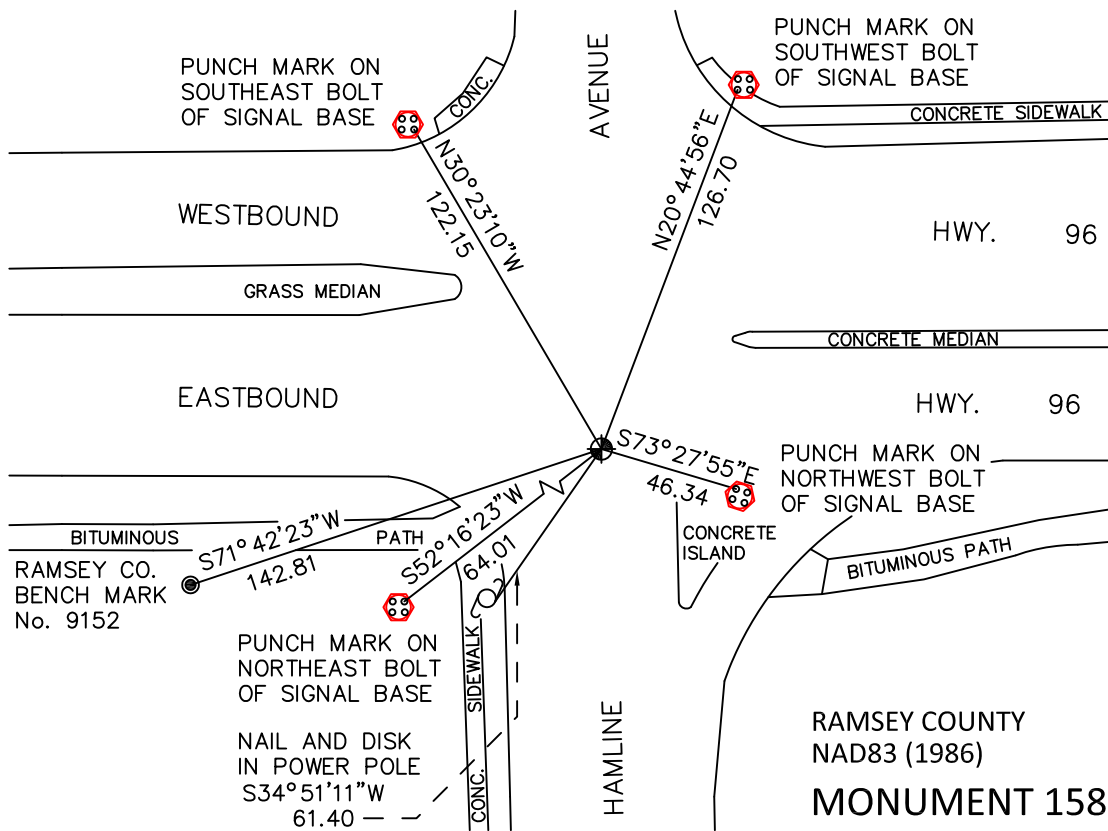

ALL DISTANCES ARE SHOWN IN U.S. SURVEY FEET.
BEARINGS ARE FOR TIE REFERENCE PURPOSES ONLY.

RAMSEY COUNTY
NAD83 (1986)
MONUMENT 158

X= 558324.419 (Easting)
Y= 205094.302 (Northing)

Statements of evidence relative to this corner are on the following page.

I hereby certify that this document has been prepared by me or under my direct supervision this _____ day of _____, 20____.

Minnesota License No. _____

- County Surveyor Deputy County Surveyor Land Surveyor

OFFICE OF COUNTY SURVEYOR
County of Ramsey

I hereby certify that this document was filed in the County Surveyor's office this _____ day of _____, 20____.

Michael D. Fiebiger, P.L.S.
Ramsey County Surveyor

MONUMENT 158

Found a granite monument, down 0.4 ft., May 31, 1974.

Placed a cast iron cap and bolt monument, June 13, 1974.

Tied monument, June 26, 1975.

Retied monument, January 22, 1992.

Monument cap loose; removed, replaced and re-cemented, June 8, 2000.

Monument removed for construction, no date given in field book.

Set a 20 in. cast iron monument down 18 in. from finished grade; cast iron manhole assembly set by contractor, October 2, 2003.

Tied monument, March 15, 2005.

Retied monument, July 29, 2010.