

MONUMENT 10SC

CERTIFICATE OF LOCATION OF GOVERNMENT CORNER

North Quarter Corner of Section 2, Township 30 North, Range 23 West, County of Ramsey, State of Minnesota.

At the corner location shown on the sketch

On September 17, 2012 found a "3RD CORRECTION LINE" cast iron monument flush in bit. road.

left monument as found raised/lowered monument removed monument (explain)

On _____ placed a _____

SKETCH OF REFERENCE TIES

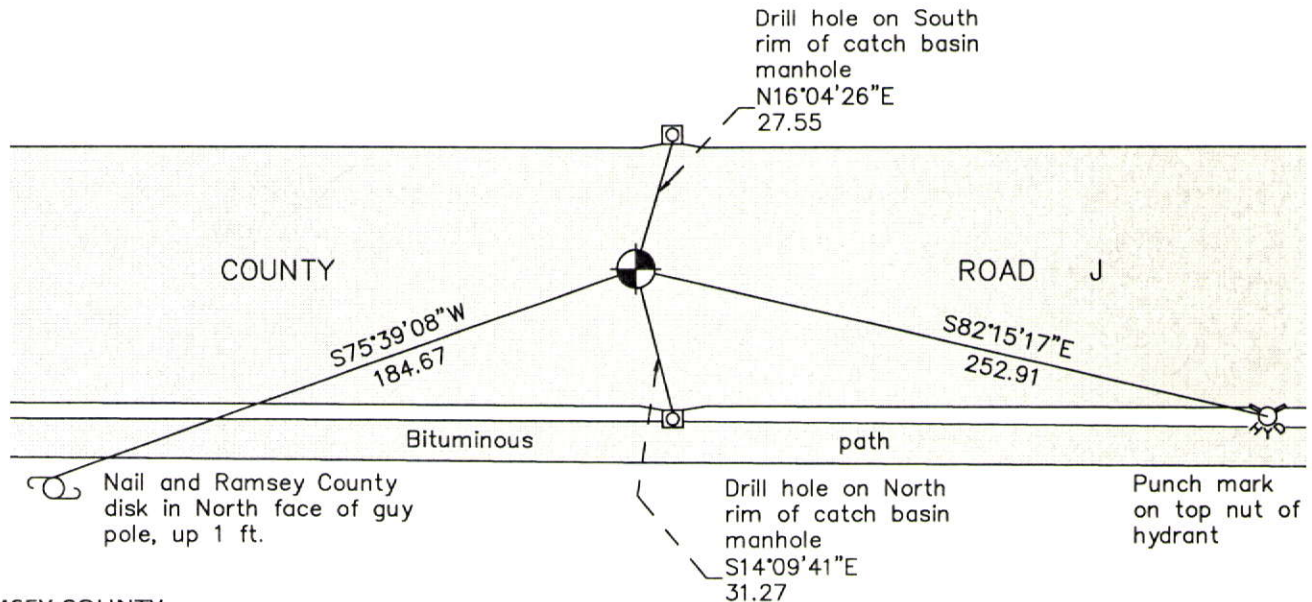

RAMSEY COUNTY
NAD83 (1986)

MONUMENT 10SC

X= 563408.804 (Easting)
Y= 221535.837 (Northing)

ALL DISTANCES ARE SHOWN IN U.S. SURVEY FEET.
BEARINGS ARE FOR TIE REFERENCE PURPOSES ONLY.

Statements of evidence relative to this corner are on the following page.

I hereby certify that this document was prepared by me or under my direct supervision and that I am a duly Licensed Land Surveyor under the laws of the State of Minnesota.

Daniel D. Baar 12-30-14

Daniel D. Baar
Minnesota License No. 45816

County Surveyor Land Surveyor
 Deputy County Surveyor

OFFICE OF COUNTY SURVEYOR
County of Ramsey

I hereby certify that this document was filed in the County Surveyor's office this 30th day of December, 20 14.

Craig W. Hinzman

Craig W. Hinzman, L.S.
Ramsey County Surveyor

MONUMENT 10SC

North Quarter Corner of Section 2, Township 30 North, Range 23 West

In establishing the 1/4 Corner on the North of Section 2, found old stake at 1/4 Corner, no Government trees, December 1896.

Set monument, August, 1900.

Checked monument, December, 1943.

Checked monument, January, 1946.

Checked monument, November, 1950.

Checked monument, March, 1952.

Found a granite monument flush and retied, October 25, 1974.

Tied out granite monument for removal by construction, June 3, 1992.

Relocated position, August 30, 1993.

Retied position, September 1, 1993.

Set 20 in. cast iron monument, September 8, 1993.

Placed "Set 45" concrete around monument, October 10, 1993.

Set a 20 in. cast iron monument marked, "3RD CORRECTION LINE", 1.77 ft. North of original granite monument closing corner location, on line between the SW Corner and S 1/4 Corner of Sec. 31, T.31, R.22, July 26, 1995.

Tied monument 10SC, December 14, 1998.

Retied monument, June 15, 2004.

Retied monument, November 21, 2006.

Found cast iron monument marked "3RD CORRECTION LINE", and checked condition of ties, September 17, 2012.