

MONUMENT 599

CERTIFICATE OF LOCATION OF GOVERNMENT CORNER

Northeast Corner of Section 2, Township 28 North, Range 22 West, County of Ramsey, State of Minnesota.

At the corner location shown on the sketch

On June 7, 2011 found a cast iron monument, flush.

left monument as found raised/lowered monument removed monument (explain)

On _____ placed a _____

SKETCH OF REFERENCE TIES

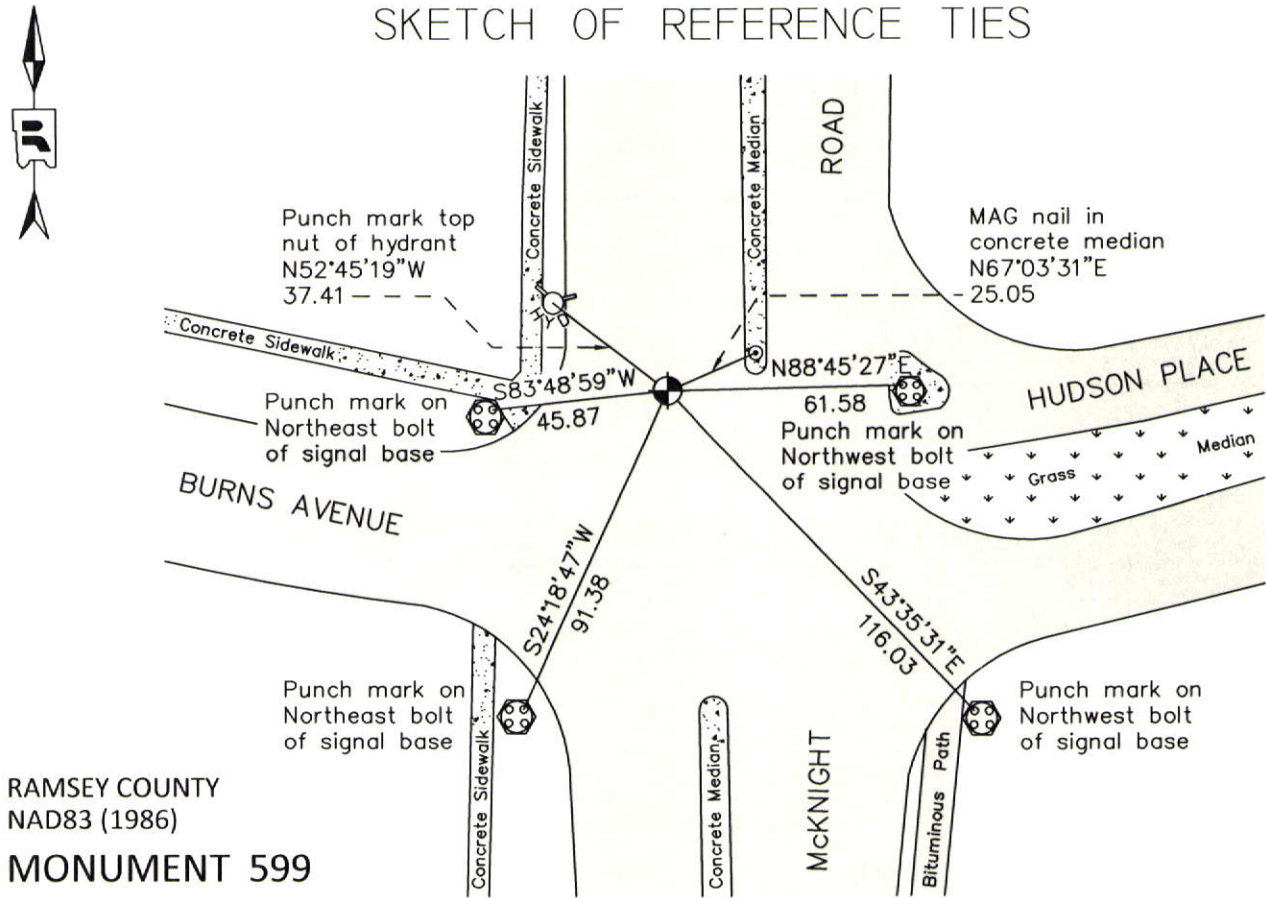

RAMSEY COUNTY
NAD83 (1986)

MONUMENT 599

X= 597958.942 (Easting)
Y= 157663.202 (Northing)

ALL DISTANCES ARE SHOWN IN U.S. SURVEY FEET.
BEARINGS ARE FOR TIE REFERENCE PURPOSES ONLY.

Statements of evidence relative to this corner are on the following page.

I hereby certify that this document was prepared by me or under my direct supervision and that I am a duly Licensed Land Surveyor under the laws of the State of Minnesota.

Daniel D. Baar 12-30-14
Date

Minnesota License No. 45816

- County Surveyor Land Surveyor
 Deputy County Surveyor

OFFICE OF COUNTY SURVEYOR
County of Ramsey

I hereby certify that this document was filed in the County Surveyor's office this 30th day of December, 20 14.

Craig W. Hinzman
Craig W. Hinzman, L.S.
Ramsey County Surveyor

MONUMENT 599

Northeast Corner of Section 2, Township 28 North, Range 22 West

Set post at Corner to Sections 1, 2, 35 & 36, Br. Oak 11 N39°E 142, Br. Oak 8 N10°W (sic), October 6, 1847.

Monument set by J.H. Armstrong, January 14, 1891 (City of St. Paul notes).

Set ties on granite monument, 1 in. above grade, February 7, 1934 (City of St. Paul notes).

Found cast iron monument flush, previously set by City of St. Paul, July 8, 1975.

Tied monument for maintenance road milling, May 15, 1998.

Found cast iron monument at grade, placed ties, left C.I.M. as found, March 31, 2001 (City of St. Paul notes).

Retied monument, July 21, 2006.

Found a broken cast iron monument over iron pin. Set new cast iron monument over pin, placed ties, September 24, 2009 (City of St. Paul notes).

Retied a cast iron monument, flush, June 7, 2011.