

# MONUMENT 401

## CERTIFICATE OF LOCATION OF GOVERNMENT CORNER

Northeast Corner of Section 15, Township 29 North, Range 23 West, County of Ramsey, State of Minnesota.

At the corner location shown on the sketch

On June 20, 2011 found a cast iron monument, within a cast iron manhole assembly.

left monument as found       raised/lowered monument       removed monument (explain)

On \_\_\_\_\_ placed a \_\_\_\_\_

### SKETCH OF REFERENCE TIES

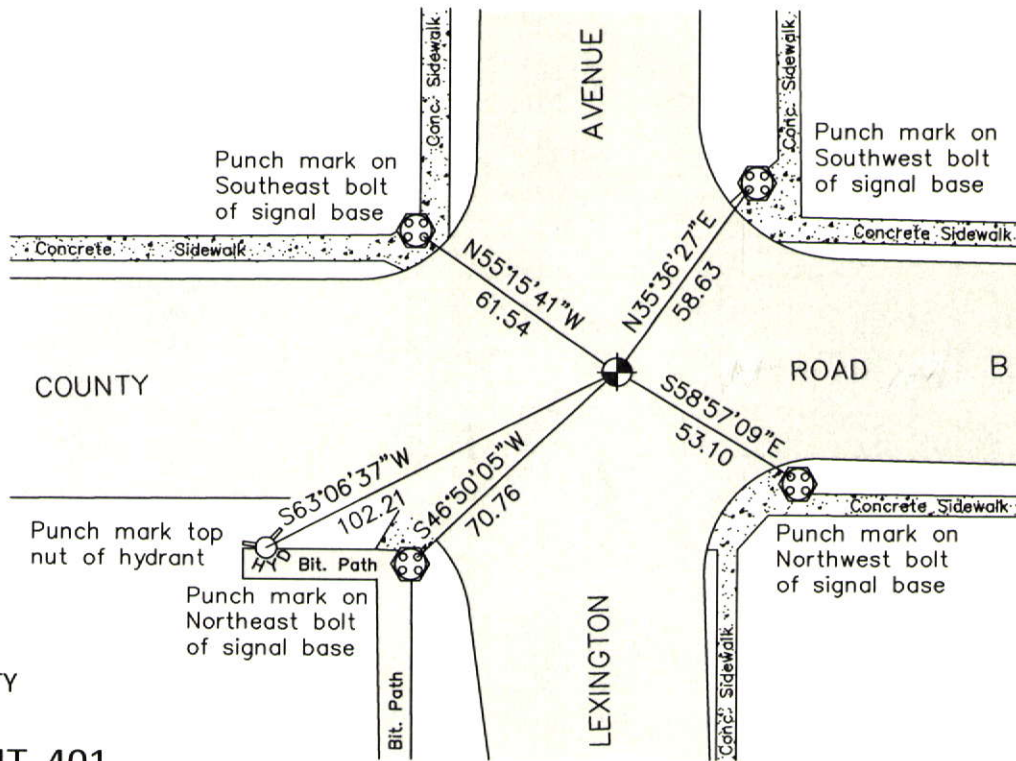

RAMSEY COUNTY  
NAD83 (1986)

### MONUMENT 401

X= 561282.781 (Easting)  
Y= 178594.622 (Northing)

ALL DISTANCES ARE SHOWN IN U.S. SURVEY FEET.  
BEARINGS ARE FOR TIE REFERENCE PURPOSES ONLY.

Statements of evidence relative to this corner are on the following page.

I hereby certify that this document was prepared by me or under my direct supervision and that I am a duly Licensed Land Surveyor under the laws of the State of Minnesota.

Daniel D. Baar      12-30-14  
Daniel D. Baar      Date  
Minnesota License No. 45816

- County Surveyor  
 Deputy County Surveyor       Land Surveyor

OFFICE OF COUNTY SURVEYOR  
County of Ramsey

I hereby certify that this document was filed in the County Surveyor's office this 30th day of December, 20 14.

Craig W. Hinzman  
Craig W. Hinzman, L.S.  
Ramsey County Surveyor

# MONUMENT 401

Northeast Corner of Section 15, Township 29 North, Range 23 West

Set post Corner to Sections 10, 11, 14 and 15, Bur Oak 12 S40°W 140, B. Oak 15 N17°W 1.69, November 3, 1847.

The Northeast Corner of Section 15 was fixed from Government Witness trees and also found iron stake at Section Corner, tied it and set monument, June 17, 1896.

AUDITOR'S SUBDIVISION No. 46 Ramsey County. Minn, shows a granite monument at this location, January 2, 1907.

Ties placed on granite monument, March, 1959 (See Ramsey County Survey, Green Book, "ROSE").

Found a P.K. nail, checked location (see Survey Book No. 1, pages 21 and 23), ~~see Sheets 3 and 4 of 4 Sheets.~~

Set a cast iron monument. No date given in survey field book.

Tied monument, July 28, 1975.

Checked monument, July 29, 1977.

Monument destroyed during road construction; reset monument, April, 1981.

Tied out monument and set a 20 in. cast iron monument, 1.5 ft. below grade, April 15 and 29, 1998.

Set a cast iron manhole assembly over monument, July 24, 1998.

Retied monument, August 10, 1999.

Retied monument, July 11, 2006.

Retied cast iron monument within a cast iron mahole assembly, June 20, 2011.