

MONUMENT 450

CERTIFICATE OF LOCATION OF GOVERNMENT CORNER

North Quarter Corner of Section 24, Township 29 North, Range 23 West, County of Ramsey, State of Minnesota.

At the corner location shown on the sketch

On July 22, 2011 found a 2 in. iron pipe, down 0.9 ft.

left monument as found raised/lowered monument removed monument (explain)

On July 25, 2011 placed a cast iron manhole assembly over 2 in. iron pipe.

SKETCH OF REFERENCE TIES

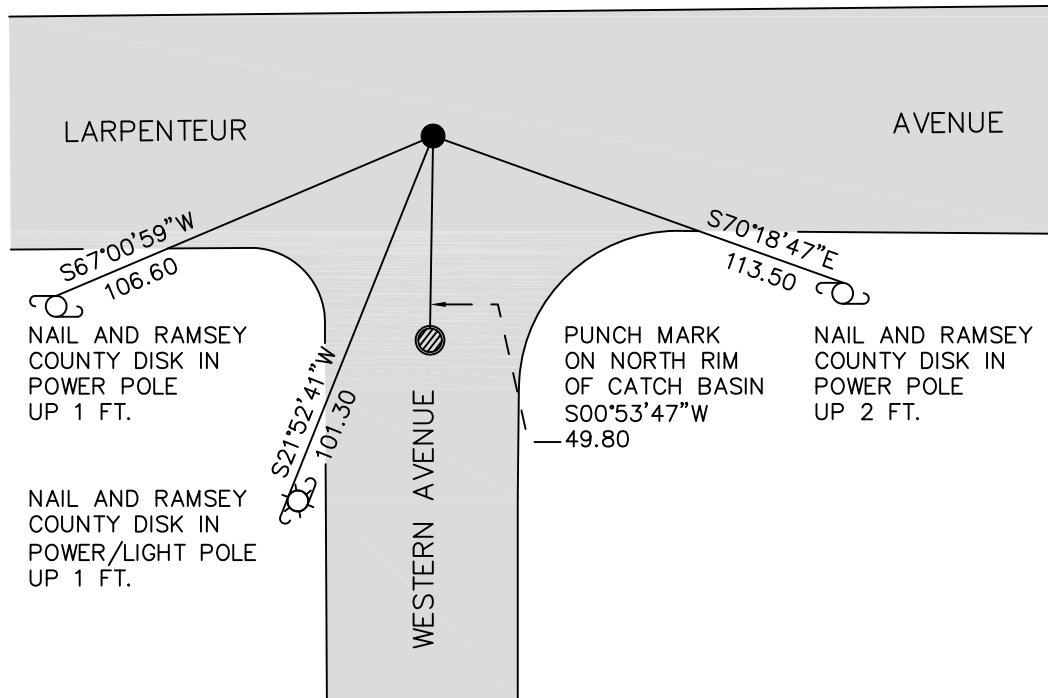

RAMSEY COUNTY
NAD83 (1986)

MONUMENT 450

X= 569175.660 (Easting)
Y= 173290.496 (Northing)

ALL DISTANCES ARE SHOWN IN U.S. SURVEY FEET.
BEARINGS ARE FOR TIE REFERENCE PURPOSES ONLY.

Statements of evidence relative to this corner are on the following page.

I hereby certify that this document was prepared by me or under my direct supervision and that I am a duly Licensed Land Surveyor under the laws of the State of Minnesota.

Daniel D. Baar Date
Minnesota License No. 45816

County Surveyor Land Surveyor
 Deputy County Surveyor

OFFICE OF COUNTY SURVEYOR
County of Ramsey

I hereby certify that this document was filed in the County Surveyor's office this _____ day of _____, 20 ____.

Craig W. Hinzman, L.S.
Ramsey County Surveyor

MONUMENT 450

The 1/4 corner between Sections 13 and 24 was fixed by city engineer, monument, no date given in book.

Cast iron pipe 2 in. dia. set approx. 10 in. below bit. surface centerline Larpeur.
Should be replaced and brought up to grade, no date given in field book.
(Per City of St. Paul Yellow Tie Books).

This monument was brought to grade and cast iron monument set in concrete installed in April, 1972 by Dick Brady.
(Per city of St. Paul Yellow Tie Books).

Found a cast iron monument, 1976.

Checked monument, August 12, 1977.

Tied monument, down +/-0.2 ft., June 7, 1990.

Retied monument, July 19, 2002.

Retied monument, August 6, 2007.

Monument loose due to road milling; removed a 6 in. "ST. PAUL CITY SURVEYOR" cast iron monument. Found a 2 in. diameter iron pipe under cast iron monument; tied, July 22, 2011.

Installed a cast iron manhole assembly over 2 in. pipe (2 in. pipe down +/-0.9 ft.), July 25, 2011.