

# MONUMENT 444

## CERTIFICATE OF LOCATION OF GOVERNMENT CORNER

North Quarter Corner of Section 21, Township 29 North, Range 23 West, County of Ramsey, State of Minnesota.

At the corner location shown on the sketch

On June 13, 2011 found a cast iron monument, within a cast iron manhole assembly.

left monument as found       raised/lowered monument       removed monument (explain)

On \_\_\_\_\_ placed a \_\_\_\_\_

### SKETCH OF REFERENCE TIES

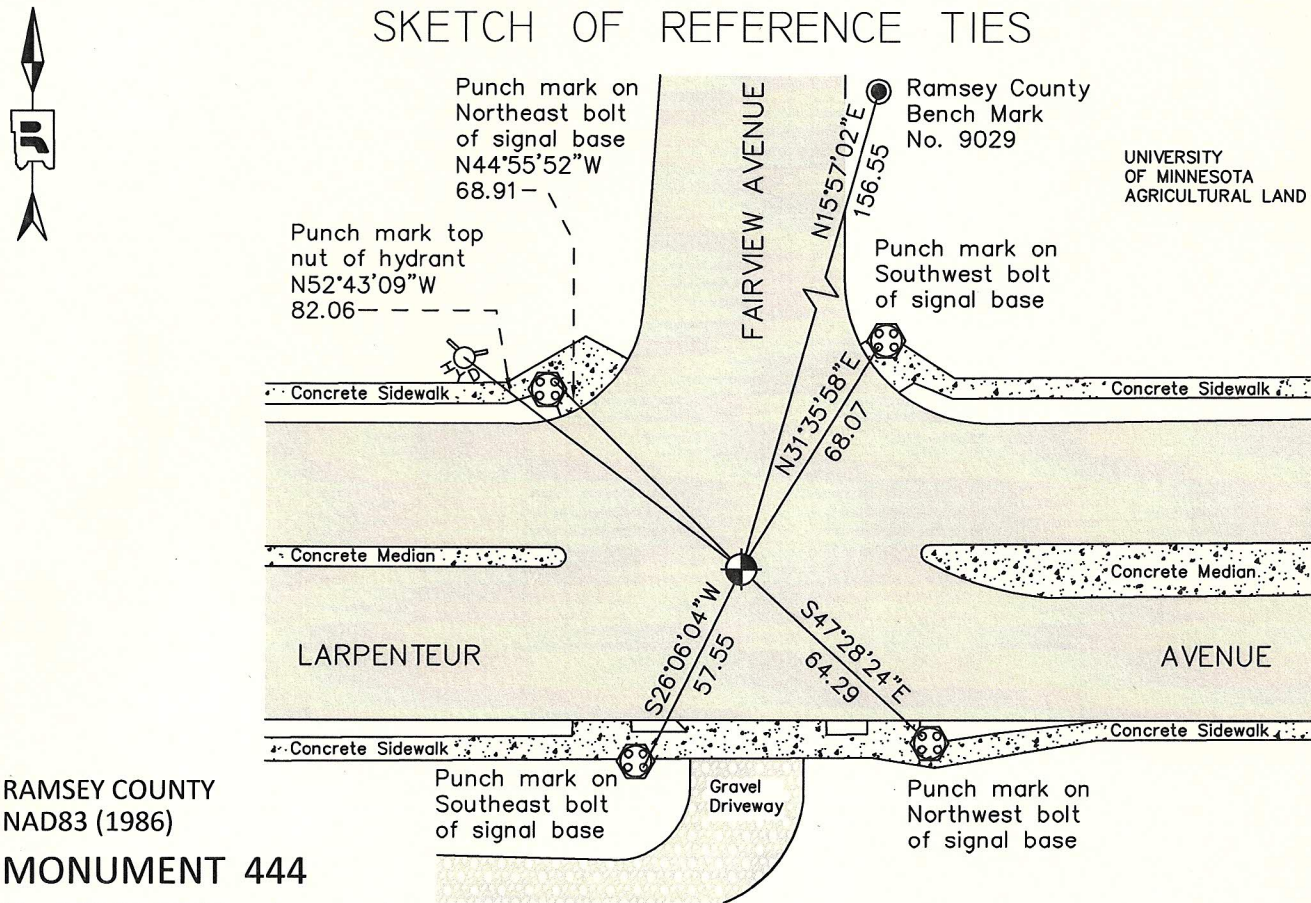

RAMSEY COUNTY  
NAD83 (1986)

### MONUMENT 444

X= 553386.539 (Easting)  
Y= 173214.510 (Northing)

ALL DISTANCES ARE SHOWN IN U.S. SURVEY FEET.  
BEARINGS ARE FOR TIE REFERENCE PURPOSES ONLY.

Statements of evidence relative to this corner are on the following page.

I hereby certify that this document was prepared by me or under my direct supervision and that I am a duly Licensed Land Surveyor under the laws of the State of Minnesota.

Daniel D. Baar      8-15-12  
Daniel D. Baar      Date

Minnesota License No. 45816

- County Surveyor       Land Surveyor  
 Deputy County Surveyor

OFFICE OF COUNTY SURVEYOR  
County of Ramsey

I hereby certify that this document was filed in the County Surveyor's office this 15<sup>th</sup> day of August, 20 12.

Craig W. Hinzman  
Craig W. Hinzman, L.S.  
Ramsey County Surveyor

# MONUMENT 444

North Quarter Corner of Section 21, Township 29 North, Range 23 West

Set 1/4 Section post, B. Oak 10 N55°W, 111, November 3, 1847.

Monument set by J.H. Armstrong, April, 1891 (City of St. Paul notes).

Found a granite monument, June 18, 1976.

Checked monument, August 12, 1977.

Found a granite monument at grade in concrete pavement and retied, April 25, 1991 (City of St. Paul notes).

Monument destroyed by construction, April, 1998.

Set a 20 in. cast iron monument down +/-18 in., July, 1998.

Contractor set a cast iron manhole assembly over monument, 1998.

Checked monument location and tied, August 19, 1998.

Retied monument, July 25, 2006.

Placed ties on the cast iron monument, November 30, 2009 (City of St. Paul notes).

Retied cast iron monument, within a cast iron manhole assembly, June 13, 2011.