

# MONUMENT 259

## CERTIFICATE OF LOCATION OF GOVERNMENT CORNER

Northeast Corner of Section 34, Township 30 North, Range 23 West, County of Ramsey, State of Minnesota.

At the corner location shown on the sketch

On July 26, 2010 found a granite monument, within a cast iron manhole assembly.

left monument as found       raised/lowered monument       removed monument (explain)

On \_\_\_\_\_ placed a \_\_\_\_\_

### SKETCH OF REFERENCE TIES

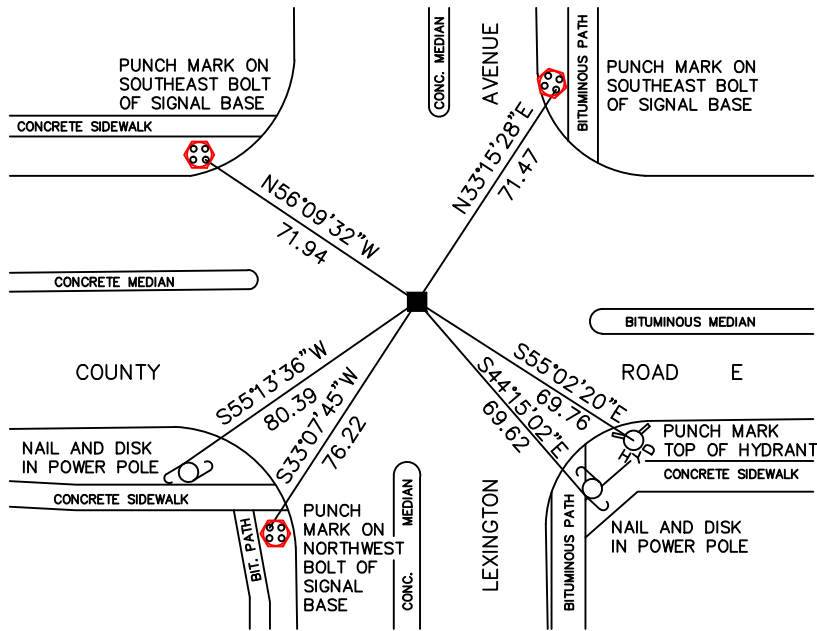

RAMSEY COUNTY  
NAD83 (1986)

### MONUMENT 259

X= 561067.265 (Easting)  
Y= 194564.214 (Northing)

ALL DISTANCES ARE SHOWN IN U.S. SURVEY FEET.  
BEARINGS ARE FOR TIE REFERENCE PURPOSES ONLY.

Statements of evidence relative to this corner are on the following page.

I hereby certify that this document has been prepared by me or under my direct supervision this \_\_\_\_\_ day of \_\_\_\_\_, 20\_\_\_\_.

\_\_\_\_\_  
SIGNATURE

Minnesota License No. \_\_\_\_\_

- County Surveyor       Land Surveyor  
 Deputy County Surveyor

OFFICE OF COUNTY SURVEYOR  
County of Ramsey

I hereby certify that this document was filed in the County Surveyor's office this \_\_\_\_\_ day of \_\_\_\_\_, 20\_\_\_\_.

\_\_\_\_\_  
SIGNATURE  
Craig W. Hinzman, L.S.  
Ramsey County Surveyor

## MONUMENT 259

Found a granite monument down 0.79 ft.; set a cast iron monument over granite, May 25, 1976.

Monument destroyed during road construction; cast iron monument set, no date given in field book.

Tied monument, February 29, 1984.

Monument removed for road milling project, July, 1987.

Granite monument found down +/-0.75 ft., short cast iron monument placed over granite, no date given in field book.

Tied monument, December 1, 1998.

Tied monument for construction, April 26, 2000.

Removed short cast iron monument; granite down +/-0.7 ft., April 28, 2000.

Placed a cast iron manhole assembly over monument, October, 2000.

Tied monument, October 25, 2005.

Retied monument, July 26, 2010.