

# MONUMENT 222

## CERTIFICATE OF LOCATION OF GOVERNMENT CORNER

South Quarter Corner of Section 23, Township 30 North, Range 22 West, County of Ramsey, State of Minnesota.

At the corner location shown on the sketch

On July 1, 2010 found a 3 1/8 inch diameter brass monument, flush.

left monument as found       raised/lowered monument       removed monument (explain)

On \_\_\_\_\_ placed a \_\_\_\_\_

### SKETCH OF REFERENCE TIES

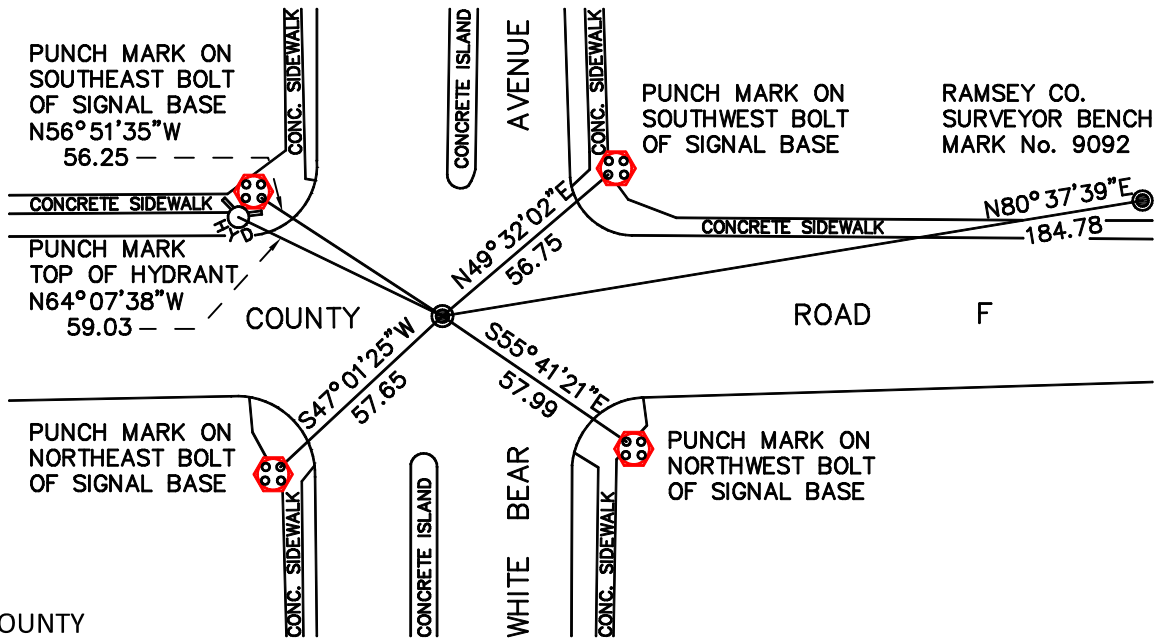

Statements of evidence relative to this corner are on the following page.

I hereby certify that this document has been prepared by me or under my direct supervision this \_\_\_\_\_ day of \_\_\_\_\_, 20\_\_\_\_.

Minnesota License No. \_\_\_\_\_

- County Surveyor       Deputy County Surveyor       Land Surveyor

OFFICE OF COUNTY SURVEYOR  
County of Ramsey

I hereby certify that this document was filed in the County Surveyor's office this \_\_\_\_\_ day of \_\_\_\_\_, 20\_\_\_\_.

Michael D. Fiebiger, P.L.S.  
Ramsey County Surveyor

## MONUMENT 222

Found a cast iron monument flush and tied, March 22, 1976.

Checked ties, June 25 1991.

Retied monument, December 3, 1998.

Monument tied out for removal by County Road F construction project.  
Set a 2 in. brass disk monument marked "Ramsey County", 2003.

Retied monument, March 29, 2005.

Retied monument, July 1, 2010.