

# MONUMENT 164

## CERTIFICATE OF LOCATION OF GOVERNMENT CORNER

North Quarter Corner of Section 19, Township 30 North, Range 22 West, County of Ramsey, State of Minnesota.

At the corner location shown on the sketch

On September 17, 2010 found a cast iron monument, within a cast iron manhole assembly.

left monument as found     lowered monument     removed monument (explain)

On \_\_\_\_\_ placed a \_\_\_\_\_

### SKETCH OF REFERENCE TIES

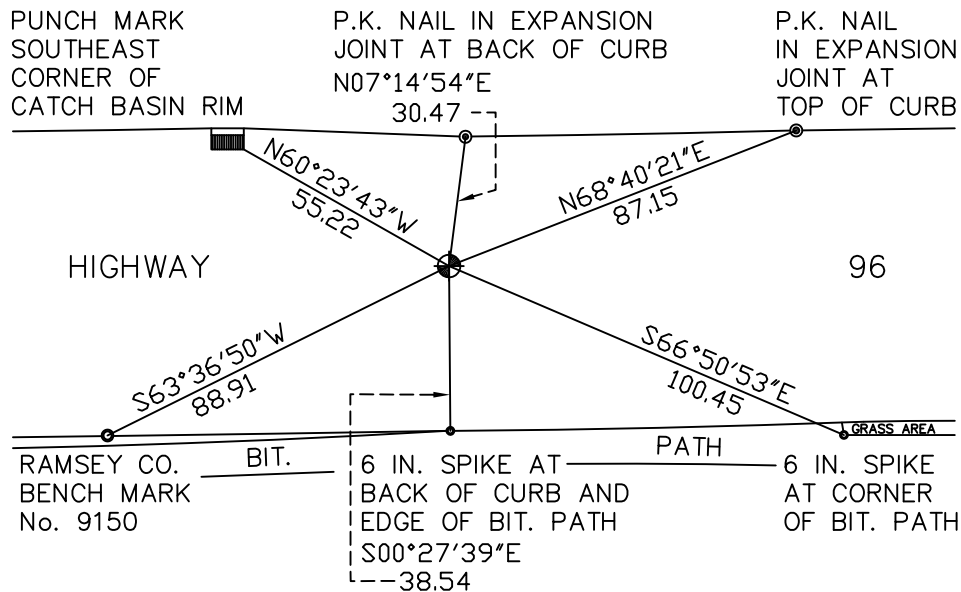

VADNAIS-SNAIL LAKES REGIONAL PARK



RAMSEY COUNTY  
NAD83 (1986)

MONUMENT 164

X= 573983.873 (Easting)  
Y= 205175.225 (Northing)

ALL DISTANCES ARE SHOWN IN U.S. SURVEY FEET.  
BEARINGS ARE FOR TIE REFERENCE PURPOSES ONLY.

Statements of evidence relative to this corner are on the following page(s).

I hereby certify that this document and the data contained herein was prepared by me or under my direct supervision this \_\_\_\_\_ day of \_\_\_\_\_, 20\_\_\_\_.

SIGNATURE

Minnesota License No. \_\_\_\_\_

- County Surveyor  
 Deputy County Surveyor     Land Surveyor

OFFICE OF COUNTY SURVEYOR  
County of Ramsey

I hereby certify that this document was filed in the County Surveyor's office on the \_\_\_\_\_ day of \_\_\_\_\_, 20\_\_\_\_.

SIGNATURE

Michael D. Fiebiger, P.L.S.  
Ramsey County Surveyor

## MONUMENT 164

Found a 2 in. iron and cap down 5 in. and set P.K.s, February 12, 1976.

Tied monument, July 18, 1992.

Relocated position; set a 20 in. cast iron monument, down 18 in. from proposed grade. Furnished 12 in. pipe and manhole casting, September 17, 1999.

Tied monument, July 19, 2001.

Retied monument, September 17, 2010.