

# MONUMENT 162

## CERTIFICATE OF LOCATION OF GOVERNMENT CORNER

South Quarter Corner of Section 13, Township 30 North, Range 23 West, County of Ramsey, State of Minnesota.

At the corner location shown on the sketch

On July 29, 2010 found a cast iron monument, within a cast iron manhole assembly.

left monument as found     lowered monument     removed monument (explain)

On \_\_\_\_\_ placed a \_\_\_\_\_

### SKETCH OF REFERENCE TIES

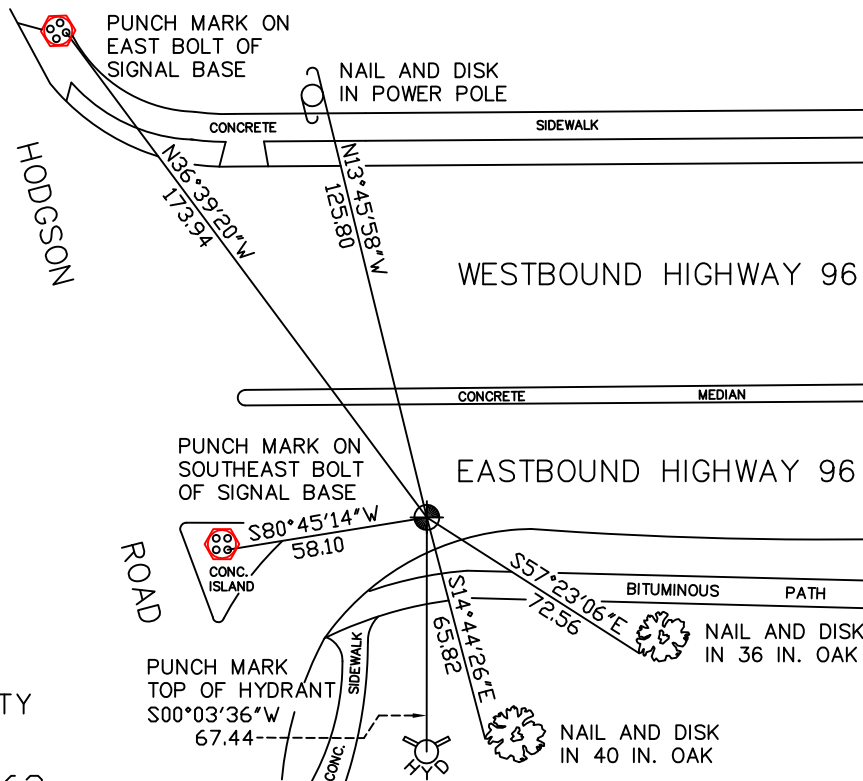

RAMSEY COUNTY  
NAD83 (1986)  
MONUMENT 162

X= 568884.561 (Easting)  
Y= 205184.906 (Northing)

ALL DISTANCES ARE SHOWN IN U.S. SURVEY FEET.  
BEARINGS ARE FOR TIE REFERENCE PURPOSES ONLY.

Statements of evidence relative to this corner are on the following page(s).

I hereby certify that this document and the data contained herein was prepared by me or under my direct supervision this \_\_\_\_\_ day of \_\_\_\_\_, 20\_\_\_\_.

SIGNATURE

Minnesota License No. \_\_\_\_\_

- County Surveyor  
 Deputy County Surveyor     Land Surveyor

OFFICE OF COUNTY SURVEYOR  
County of Ramsey

I hereby certify that this document was filed in the County Surveyor's office on the \_\_\_\_\_ day of \_\_\_\_\_, 20\_\_\_\_.

SIGNATURE

Michael D. Fiebiger, P.L.S.  
Ramsey County Surveyor

## MONUMENT 162

Found a 3/4 in. diameter, 2 ft. long solid rod; replaced with a cast iron monument, June 10, 1974.

Tied and removed monument for construction by State, July 7, 1982.

Replaced a 20 in. cast iron monument and tied, October 14, 1982.

Set a sign and post, August 28, 1998.

Removed sign, post and monument for construction, April 27, 2000.

Set a 20 in. cast iron monument, down 18 in. from finished grade, set a 12 in. tube and cast iron manhole, July 23, 2000.

Tied monument, found in a cast iron manhole assembly, March 20, 2001.

Retied monument, July 29, 2010.