

MONUMENT 55

CERTIFICATE OF LOCATION OF GOVERNMENT CORNER

Southwest Corner of Section 4, Township 30 North, Range 23 West, County of Ramsey, State of Minnesota.

At the corner location shown on the sketch

On October 3, 2008 found a cast iron monument, flush.

left monument as found lowered monument removed monument (explain)

On _____ placed a _____

SKETCH OF REFERENCE TIES

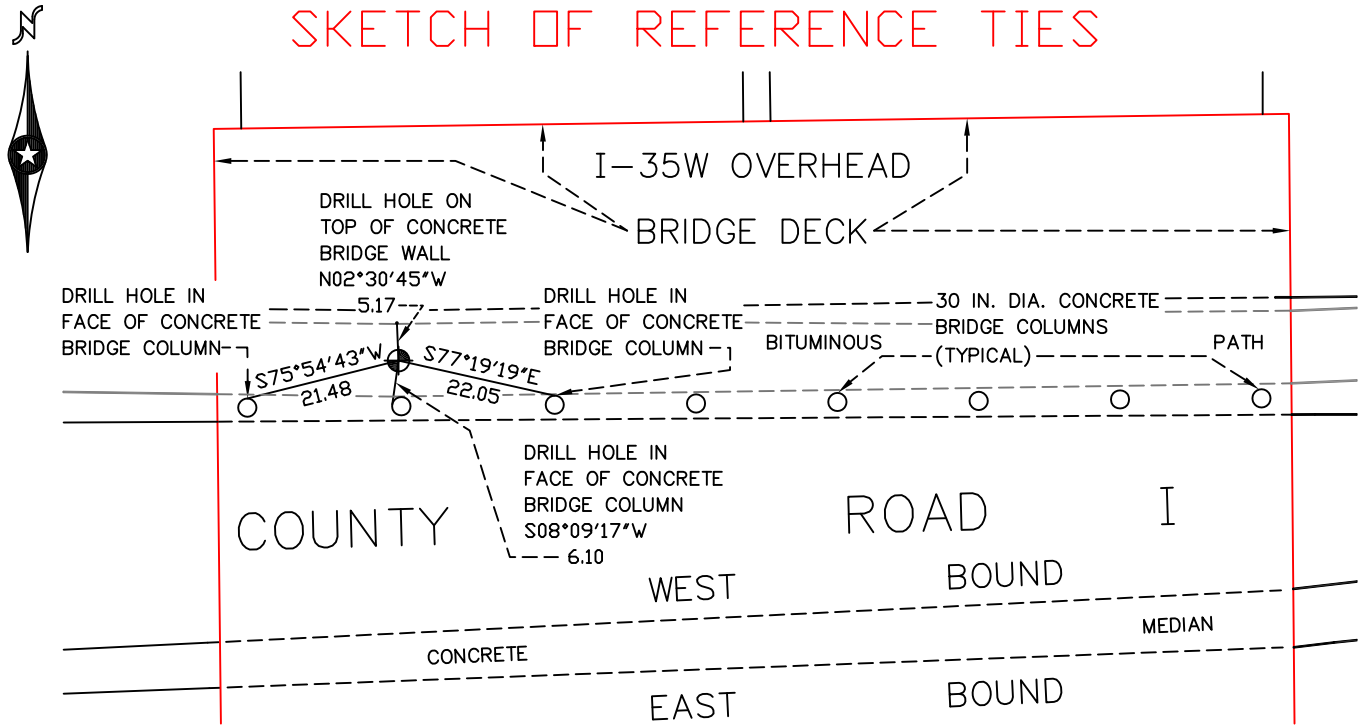

RAMSEY COUNTY
NAD83 (1986)

MONUMENT 55

X= 550292.811 (Easting)
Y= 215623.368 (Northing)

ALL DISTANCES ARE SHOWN IN U.S. SURVEY FEET.
BEARINGS ARE FOR TIE REFERENCE PURPOSES ONLY.

Statements of evidence relative to this corner are on the following page(s).

I hereby certify that this document and the data contained herein was prepared by me or under my direct supervision this _____ day of _____, 20____.

SIGNATURE

Minnesota License No. _____

- County Surveyor
 Deputy County Surveyor Land Surveyor

OFFICE OF COUNTY SURVEYOR
County of Ramsey

I hereby certify that this document was filed in the County Surveyor's office on the ____ day of _____, 20____.

David D. Claypool, P.L.S., County Surveyor

By _____, Deputy

MONUMENT 55

Found a Minnesota Highway Department disc flush, on north slope under bridge, approximately four feet above the road, and retied, January 28, 1976.

Monument destroyed by path construction and tied out by B.R.W. Engineering, no date given in field book.

Using the position of a P.K. nail that was set in the Fall of 1990, placed a cast iron monument.

Checked ties, June 4, 1991.

Retied monument, July 2, 2003.

Retied monument, October 3, 2008.