

MONUMENT 202

CERTIFICATE OF LOCATION OF GOVERNMENT CORNER

South Quarter Corner of Section 19, Township 30 North, Range 23 West, County of Ramsey, State of Minnesota.

At the corner location shown on the sketch

On July 30, 2007 found a brass cap, flush with concrete bridge deck.

left monument as found lowered monument removed monument (explain)

On _____ placed a _____

SKETCH OF REFERENCE TIES

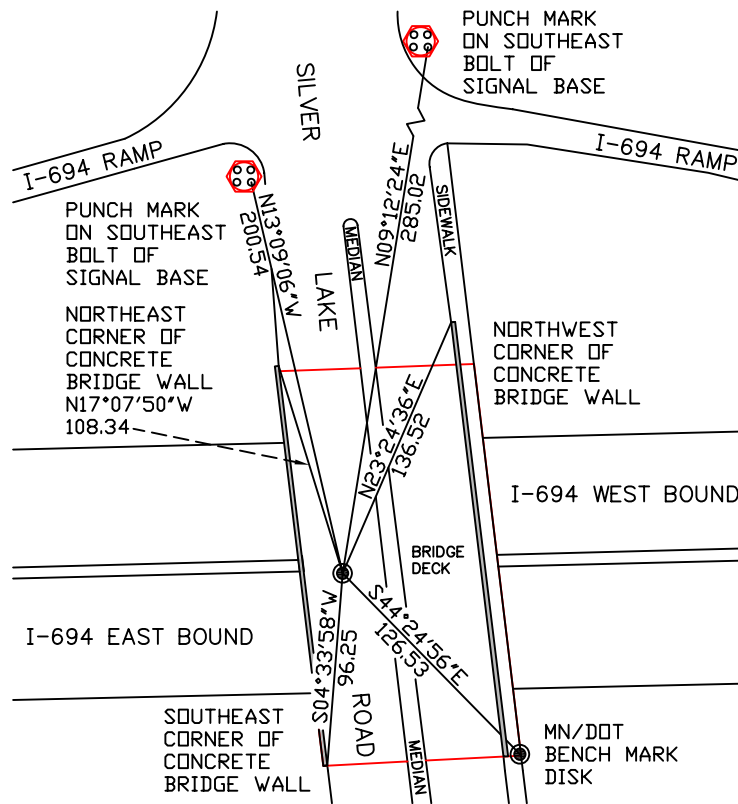

RAMSEY COUNTY
NAD83 (1986)
MONUMENT 202

X= 542585.703 (Easting)
Y= 199708.799 (Northing)

ALL DISTANCES ARE SHOWN IN U.S. SURVEY FEET.
BEARINGS ARE FOR TIE REFERENCE PURPOSES ONLY.

Statements of evidence relative to this corner are on the following page(s).

I hereby certify that this document and the data contained herein was prepared by me or under my direct supervision this _____ day of _____, 20____.

SIGNATURE

Minnesota License No. _____

County Surveyor
 Deputy County Surveyor Land Surveyor

OFFICE OF COUNTY SURVEYOR
County of Ramsey

I hereby certify that this document was filed in the County Surveyor's office on the ____ day of _____, 20____.

David D. Claypool, P.L.S., County Surveyor

By _____, Deputy

MONUMENT 202

Monument location is in I-694 right of way.

Bridge rebuilt and a brass plug monument was placed by MN/DOT to represent the south quarter corner, 1985.

Tied out brass plug monument, November 13, 2002.

Retied monument, July 30, 2007.