

MONUMENT 267

CERTIFICATE OF LOCATION OF GOVERNMENT CORNER

Southwest Corner of Section 28, Township 30 North, Range 22 West, County of Ramsey, State of Minnesota.

At the corner location shown on the sketch

On October 26, 2005 found a cast iron monument.

left monument as found lowered monument removed monument (explain)

On _____ placed a _____

SKETCH OF REFERENCE TIES

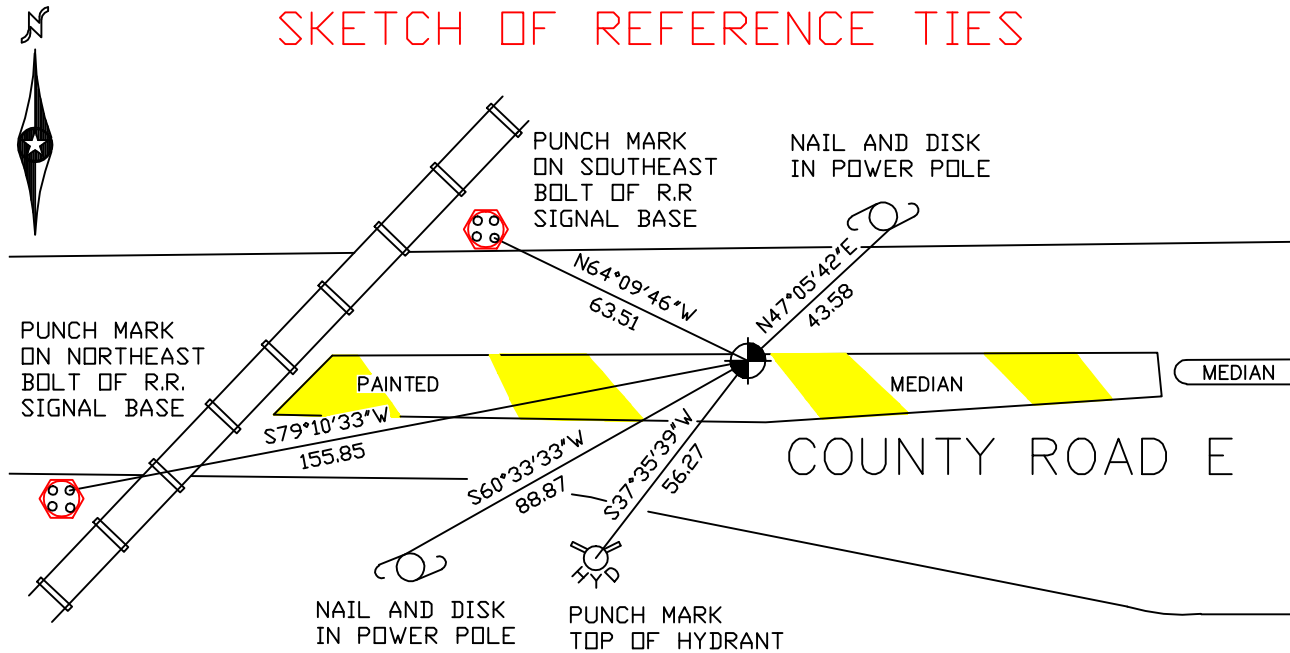

RAMSEY COUNTY

NAD83 (1986)

MONUMENT 267

X= 581882.814 (Easting)

Y= 194676.783 (Northing)

ALL DISTANCES ARE SHOWN IN U.S. SURVEY FEET.
BEARINGS ARE FOR TIE REFERENCE PURPOSES ONLY.

Statements of evidence relative to this corner are on the following page(s).

I hereby certify that this document and the data contained herein was prepared by me or under my direct supervision this _____ day of _____, 20____.

SIGNATURE

Minnesota License No. _____

County Surveyor Land Surveyor

OFFICE OF COUNTY SURVEYOR

County of Ramsey

I hereby certify that this document was filed in the County Surveyor's office on the ____ day of _____, 20____.

David D. Claypool, P.L.S., County Surveyor

By _____, Deputy

MONUMENT 267

Found pipe down 0.3 ft., April, 1974.

Found 1 in. diameter, 2 ft. long solid iron, down 4 ¼ in., May 16, 1975.

Found granite monument down 1.16 ft. and is 0.89 ft. east and 0.18 ft. north of the found iron, May 19, 1975.

Placed cast iron monument over granite monument, May 20, 1975.

Checked and retied cast iron monument, June 28, 1991.

Set 20 in. cast iron monument, September, 1994.

Retied monument, December 8, 1998.

Retied monument, October 26, 2005.