

MONUMENT 127

CERTIFICATE OF LOCATION OF GOVERNMENT CORNER

Center of Section 18, Township 30 North, Range 23 West, County of Ramsey, State of Minnesota.

At the corner location shown on the sketch

On March 1, 2005 found a cast iron monument within a cast iron manhole assembly.

left monument as found, lowered monument, removed monument (explain)

On _____ placed a _____

SKETCH OF REFERENCE TIES

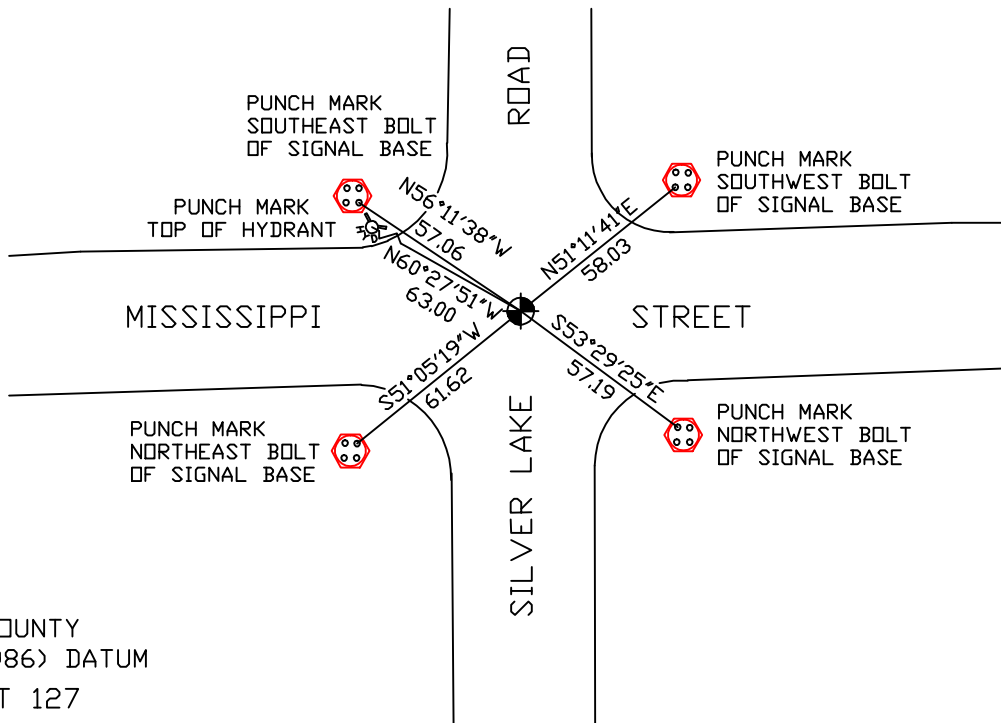

RAMSEY COUNTY
NAD83 (1986) DATUM
MONUMENT 127

X=542469.019 (Easting)
Y=207602.258 (Northing)

ALL DISTANCES ARE SHOWN IN U.S. SURVEY FEET.
BEARINGS ARE FOR TIE REFERENCE PURPOSES ONLY.

Statements of evidence relative to this corner are on the following page(s).

I hereby certify that this document and the data contained herein was prepared by me or under my direct supervision this _____ day of _____, 20____.

SIGNATURE

Minnesota License No. _____
 Land Surveyor Professional Engineer
 County Surveyor County Engineer

OFFICE OF COUNTY SURVEYOR

County of Ramsey

I hereby certify that this document was filed in the County Surveyor's office on the ____ day of _____, 20____.

David D. Claypool, P.L.S., County Surveyor

By _____, Deputy

MONUMENT 127

Found cast iron monument flush, June 17, 1974.

Retied monument, June 26, 1975.

Retied monument, January 14, 1992.

Removed 20 in. cast iron monument; found 1 in. iron, 18 in. long, 21 in. down. Removed iron and set 20 in. cast iron in place of iron. Iron not in same place as old cast iron monument. Set manhole assembly, November 13, 1998.

Tied out monument for removal during reconstruction of Silver Lake Road, April 12, 2002.

Removed manhole and 20 in. cast iron monument, May 8, 2003.

Reset 20 in. cast iron monument down 18 in; contractor to set cast iron manhole assembly, November 17, 2003.

Retied monument, March 1, 2005.