

1/4 sec cor Between Sec 7 and 8 T29 R22

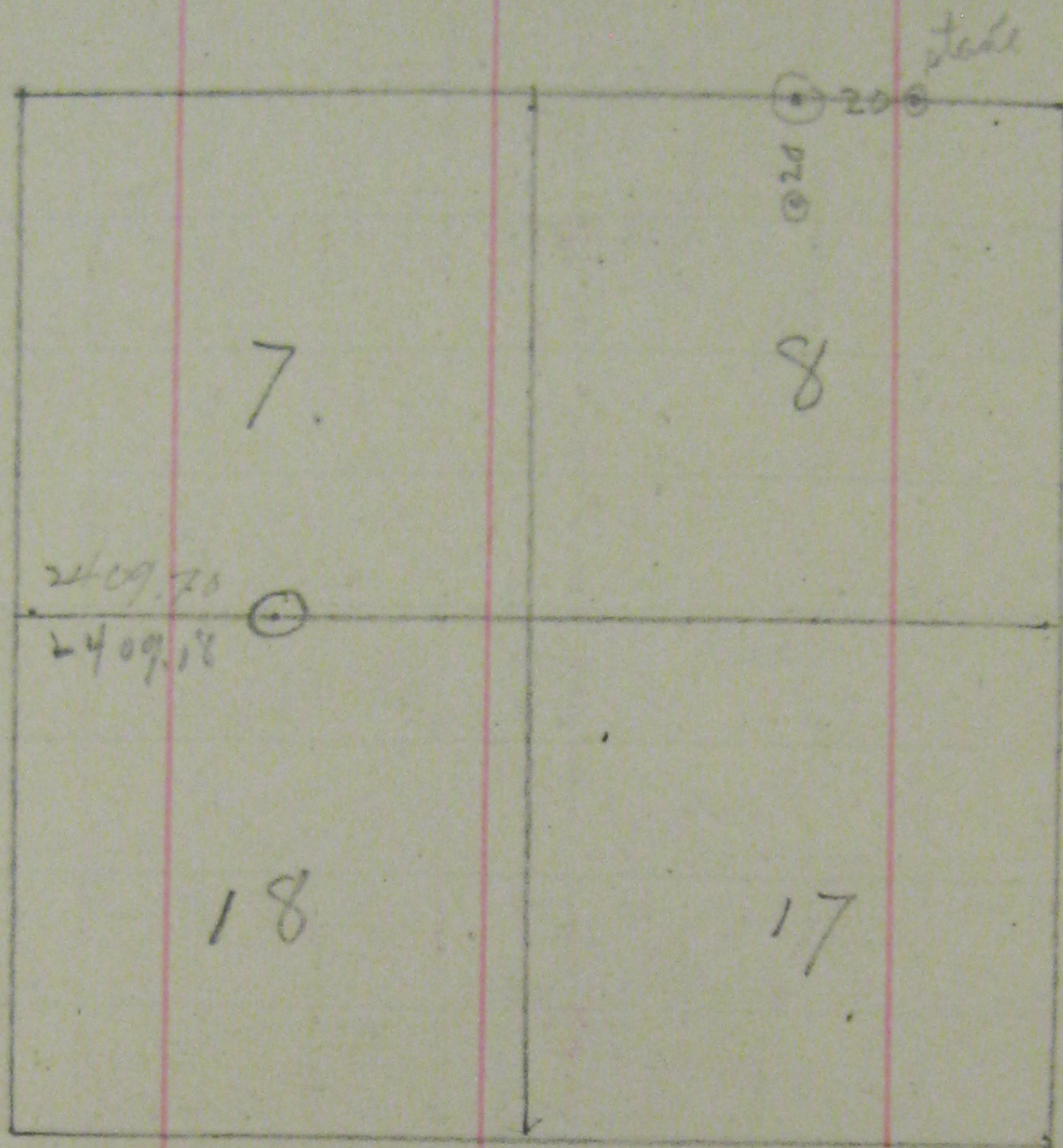

April 23rd 1895 Filed 1/4 cor between
 Sections 5 and 8 T29 R22 by running
 up from Monument at center of Section 8
 and running East on Section Line N side
 Sec 8 using subd stakes found
 This cor is ready for Monument found Boulder
 from this corner East on section line to
 Lake Harvair 217.0 feet.