

(Continued)

If the N.E. Cor. Sec. 11, -29-22 were to move W. 0.48' it would match the prorated MHD distances to R. county distances and increase the  $\frac{1}{4}$  closer to CW record. However to much platting has been done off the position of the existing C.I. to move it now.

SEC. 11,

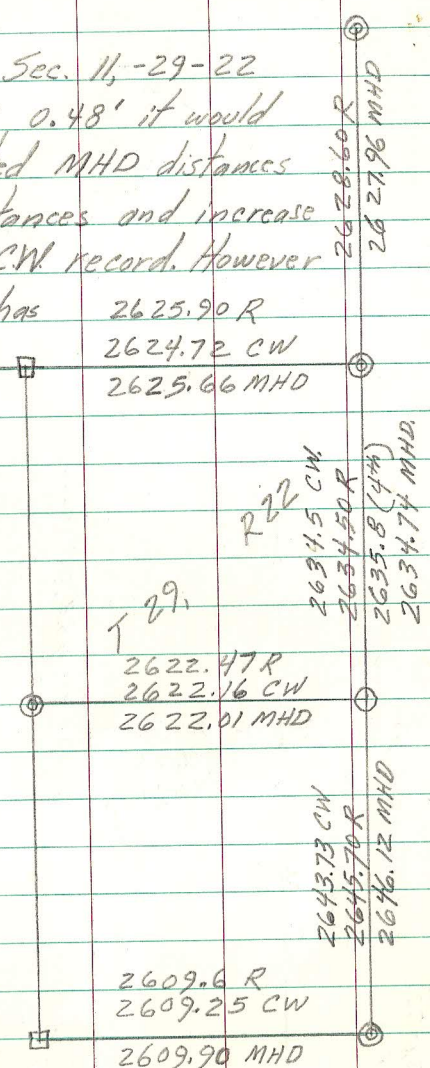

(4th) = 4th Add. to N. St. Paul (1887)  
 C.W. = Castlewood (1915)  
 MHD = Minn. Hwy Dept (1975)  
 R = Co. Measurement (1900±)  
 Comp. = computed theoretical center

