

SECTION 3, T30, R22 (S 1/2)

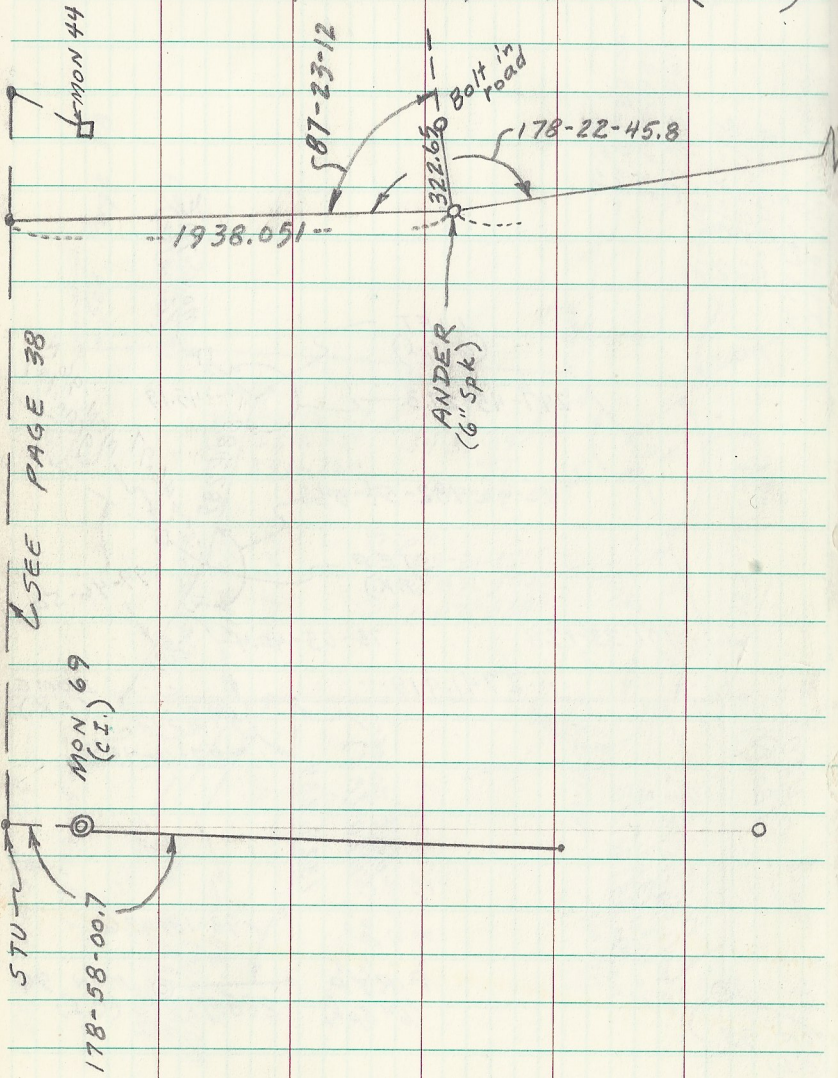

SEE PAGE 38

STU

MON 69 (C.I.)

178-58-00.7

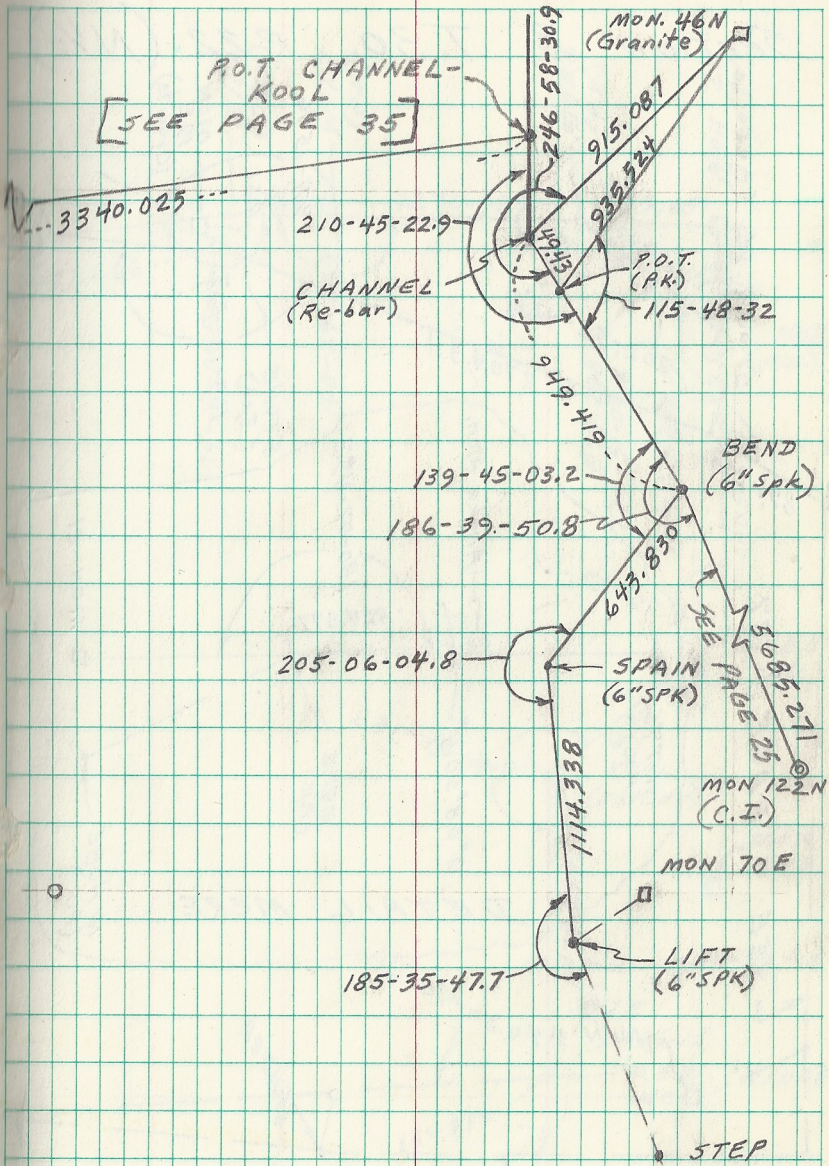

[SEE PAGE 35]

P.O.T CHANNEL-KOOL

3340.025

210-45-22.9

CHANNEL (Re-bar)

MON. 46N (Granite)

915.087

P.O.T. (PK.)

115-48-32

949.419

139-45-03.2

BEND (6\"/>

186-39-50.8

643.830

SEE PAGE 25

518.5211

MON 122N (C.I.)

205-06-04.8

SPAIN (6\"/>

BEEHIVE

MON 70E

185-35-47.7

LIFT (6\"/>

STEP