

CERTIFICATE OF LOCATION OF GOVERNMENT CORNER

CITY MON. NO. 182

OLD INDEX NO. 145

North 1/4 Corner of Section 8 Township 28 Range 22, 4th P.M.

STATE OF MINNESOTA, County of Ramsey

At the corner location shown on the sketch:

On April 1, 2005 found a PK set out by GPS, checked

ties from previous certificate. probed 5.0' below asphalt, found

left monument as found lowered monument removed monument (explain) nothing

On April 6, 2005 placed a cim to grade in concrete

4
N

SKETCH OF REFERENCE TIES

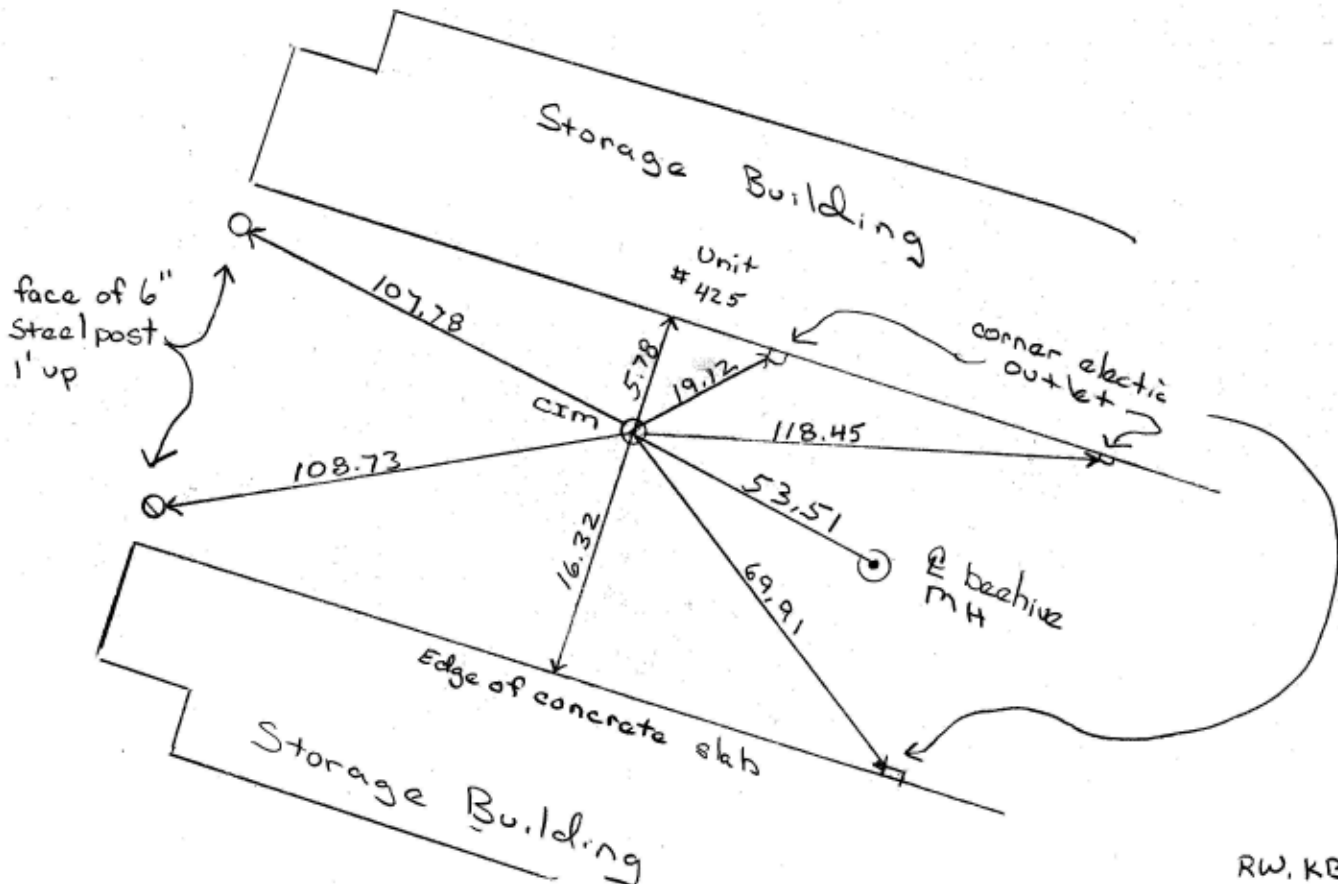

RW, KB

Statement of evidence relative to this corner is available from the St. Paul Public Works Dept., Survey Division

I hereby certify that this document and the data contained herein was prepared by me or under my direct supervision.

Michael P Murphy 4/18/05
SIGNATURE DATE

Registration No. 44,001

- Land Surveyor County Surveyor
- Professional Engineer
- Chief Surveyor, City of St. Paul

Office of The County Recorder, County of Ramsey

I hereby certify that this document was filed in the county

Recorders office at _____ M. on the _____ day of _____

County Recorder _____

By _____, Deputy

DOCUMENT NUMBER _____

Elevations for CIM 182

Bm	3.43	12.35		8.92	
Bm	2.31	12.04	2.62	9.73	(9.74)
Bm	2.79	12.42	2.41	9.63	
Bm	2.09	12.45	2.06	10.36	
Bm	2.19	11.26	3.38	9.07	
Bm	2.50	11.55	2.21	9.05	
Bm	3.30	12.60	2.25	9.30	
Bm	2.63	14.08	1.15	11.45	
TP	6.89	15.30	5.67	8.41	
Bm			4.76	10.54	
					(10.65)

FB # 1735

AW 4-12-05
MS
JA

65

HYD NWC Plato E Eva
 HYD NWC Plato E State
 HYD WS State 150' S of Plato
 HYD WS State in front # 253 State
 HYD WS State in front # 295 State
 HYD WS State across from # 308 State
 HYD NWC State E Florida
 HYD NWC State E Eva
 top curb at driveway
 CIM 182 in Storage Yard
 GPS Elevation