

CERTIFICATE OF LOCATION OF GOVERNMENT CORNER

CITY MON. NO. 0147

OLD INDEX NO. 2221

NE Corner of Section 2 Township 28 Range 22, P.M.

STATE OF MINNESOTA, County of Ramsey

At the corner location shown on the sketch:

On SEPT 24, 2009 found a BROKEN CIM (FROM RAMSEY CO. PAVING JOB)
date

NOTE: FOUND IRON PIN 1.5 BELOW MILLED ASPHALT, PLACED NEW CIM OVER PIN

- left monument as found lowered monument removed monument (explain)

On SEPT. 24 2009 placed a NEW CIM - TIES - PHOTOS - AND GPS
date

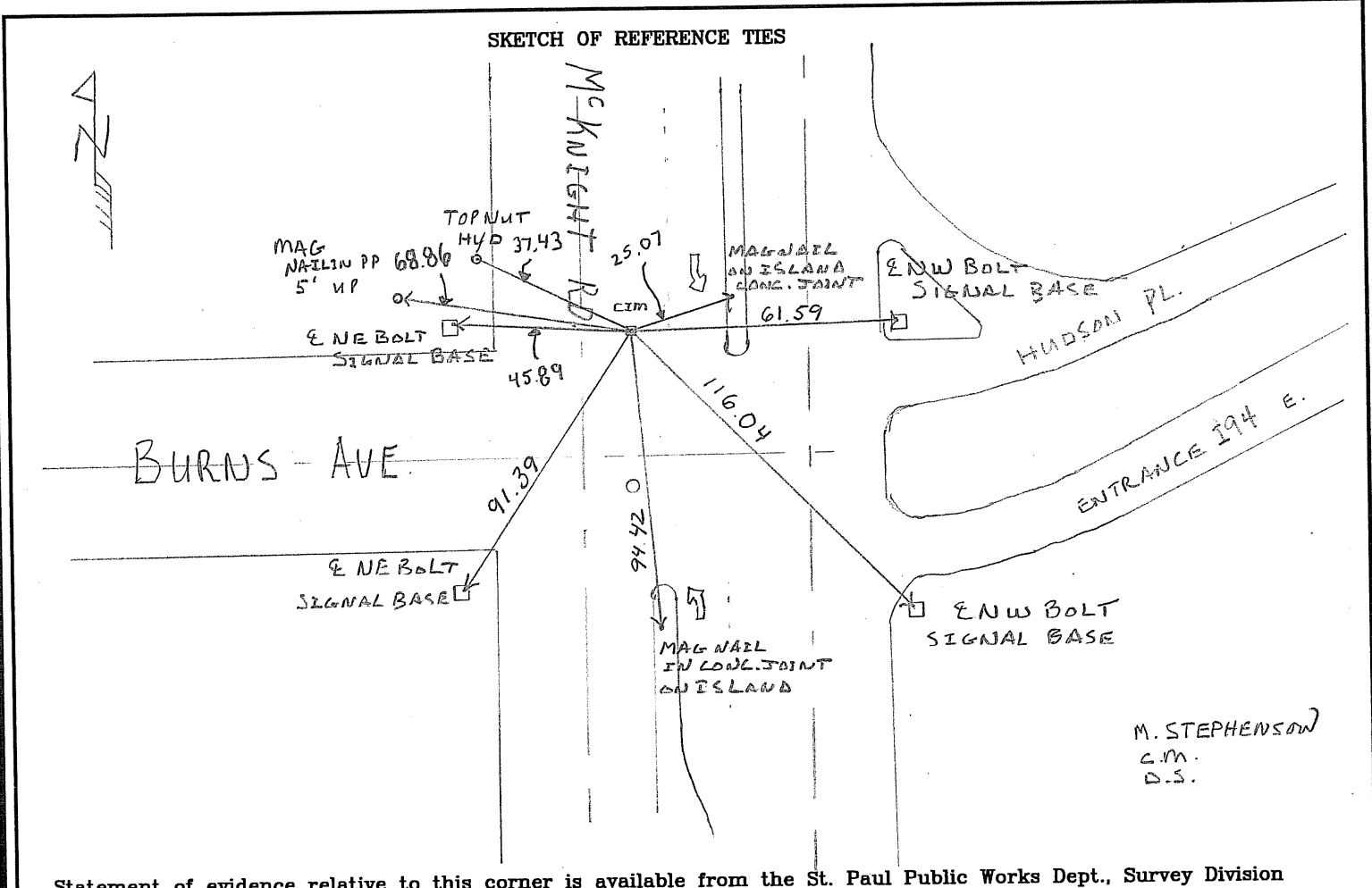

M. STEPHENSON
C.M.
D.S.

Statement of evidence relative to this corner is available from the St. Paul Public Works Dept., Survey Division

I hereby certify that this document and the data contained herein was prepared by me or under my direct supervision.

[Signature] OCT 7, 2009
SIGNATURE DATE

Registration No. 44880

Land Surveyor County Surveyor

Professional Engineer

Chief Surveyor, City of St. Paul

Office of The County Recorder, County of Ramsey

I hereby certify that this document was filed in the county

Recorders office at _____ M. on the _____ day of _____

County Recorder _____

By _____, Deputy

DOCUMENT NUMBER _____