

CERTIFICATE OF LOCATION OF GOVERNMENT CORNER

CITY MON. NO. 138

OLD INDEX NO. 107

NORTH 1/4 Corner of Section 6 Township 28 Range 22, 4TH P.M.

STATE OF MINNESOTA, County of Ramsey

At the corner location shown on the sketch:

On SEPT 28 2000 found a REBAR W/ BROKEN CAP APPROX. 0.1' N &

0.1' WEST OF SET OUT POINT, APPROX. 0.05' BELOW GRASS SURFACE

- left monument as found
- lowered monument
- removed monument (explain)

On SEPT 28, 2000 placed a CIM IN CONC FROM SDR 33 SETOUT W/ SET 2110

SKETCH OF REFERENCE TIES

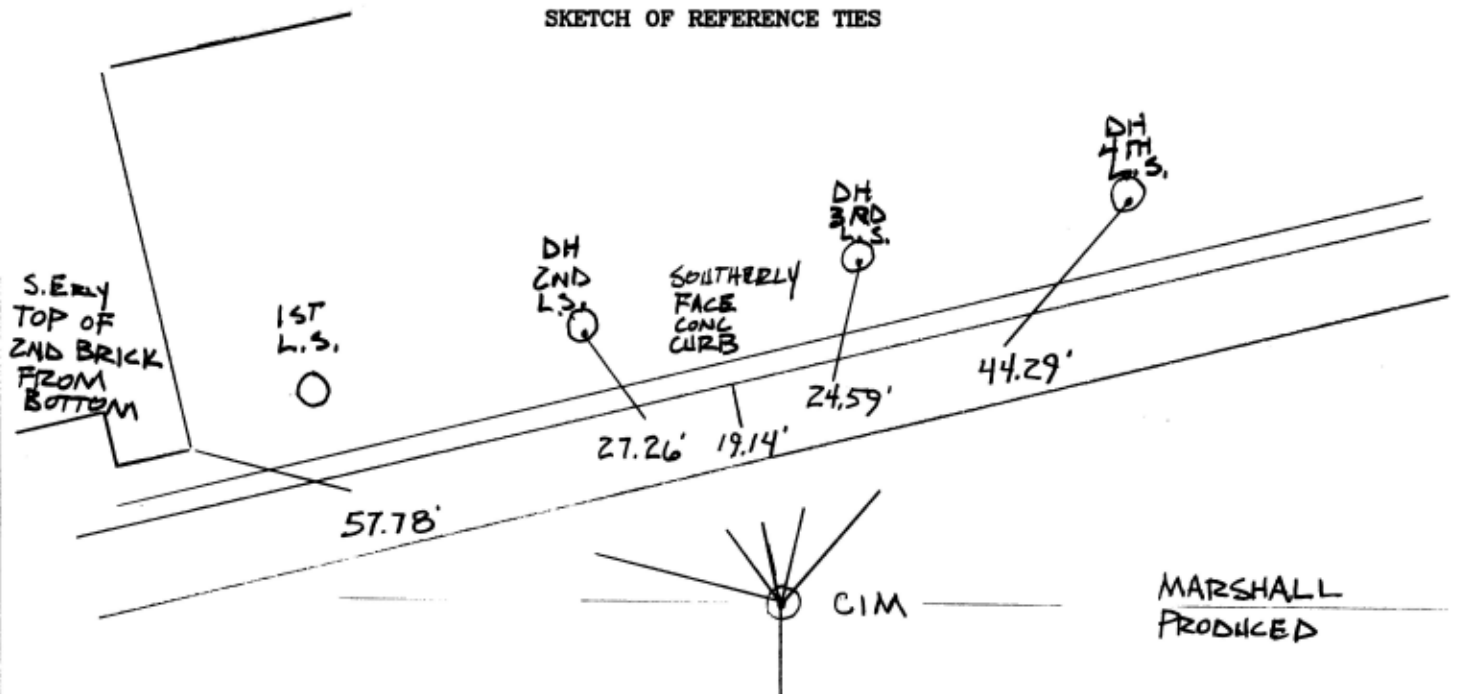

MARSHALL PRODUCED

JACKSON PRODUCED

TIED BY
JM DN
SEPT. 28, 2000

Statement of evidence relative to this corner is available from the St. Paul Public Works Dept., Survey Division

I hereby certify that this document and the data contained herein was prepared by me or under my direct supervision.

Jeffrey J. Janso 10/2/00
SIGNATURE DATE

Registration No. 23144

- Land Surveyor
- County Surveyor
- Professional Engineer
- Chief Surveyor, City of St. Paul

Office of The County Recorder, County of Ramsey

I hereby certify that this document was filed in the county

Recorders office at _____ M. on the _____ day of _____

County Recorder _____

By _____, Deputy

DOCUMENT NUMBER _____