

# CERTIFICATE OF LOCATION OF GOVERNMENT CORNER

CITY MON. NO. 0121  
 OLD INDEX NO. 0093

CENTER Corner of Section 33 Township 29 Range 22, 4<sup>th</sup> P.M.

STATE OF MINNESOTA, County of Ramsey  
 At the corner location shown on the sketch:

On NOV 21 2012 found a GM 0.2 BELOW STREET GRADE  
date

- left monument as found       lowered monument       removed monument (explain)

On NOV 21 2012 placed a TIES - PHOTOS - GPS  
date

SKETCH OF REFERENCE TIES

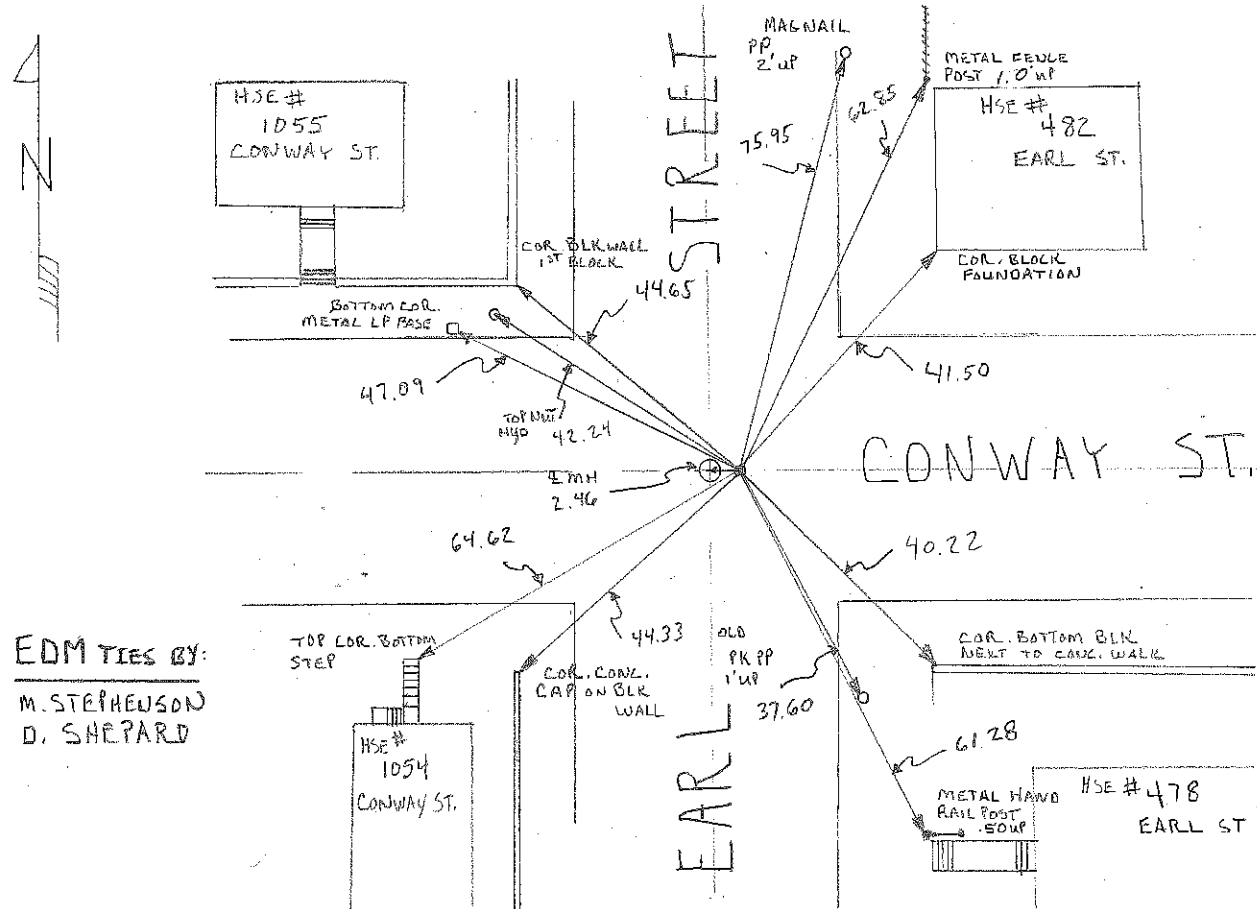

EDM TIES BY:  
 M. STEPHENSON  
 D. SHEPARD

Statement of evidence relative to this corner is available from the St. Paul Public Works Dept., Survey Division

I hereby certify that this document and the data contained herein was prepared by me or under my direct supervision.

[Signature] DEC 24, 2012  
SIGNATURE DATE  
 Registration No. 44880

- Land Surveyor       County Surveyor  
 Professional Engineer  
 Chief Surveyor, City of St. Paul

Office of The County Recorder, County of Ramsey

I hereby certify that this document was filed in the county  
 Recorders office at \_\_\_\_\_ M. on the \_\_\_\_\_ day of \_\_\_\_\_

County Recorder \_\_\_\_\_

By \_\_\_\_\_, Deputy

DOCUMENT NUMBER \_\_\_\_\_