

CERTIFICATE OF LOCATION OF GOVERNMENT CORNER

CITY MON. NO. 53

OLD INDEX NO. 00174

NW. SEC. 30 Corner of Section 30 Township 29 Range 22, 4TH P.M.

STATE OF MINNESOTA, County of Ramsey

At the corner location shown on the sketch:

On 4-4-2012 found a GM EE MARYLAND-RICE ST
date

(REMOVED FOR STREET CONSTRUCTION)

- left monument as found lowered monument removed monument (explain)

On MAY 26, 2012 placed a CIM BELOW ASPHALT GRADE - GPS - PHOTOS - TIES
date

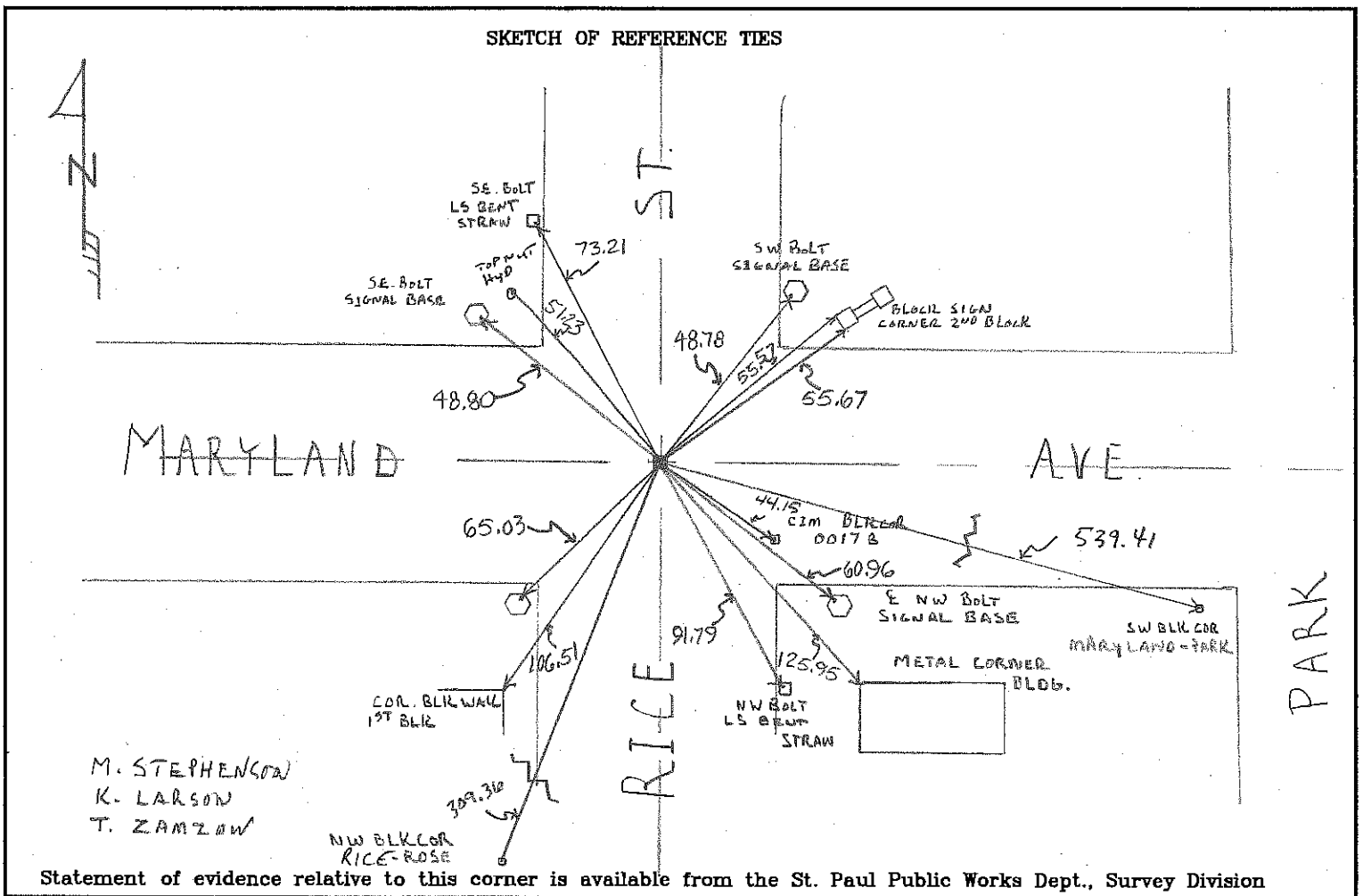

I hereby certify that this document and the data contained herein was prepared by me or under my direct supervision.

Office of The County Recorder, County of Ramsey

I hereby certify that this document was filed in the county

Recorders office at _____ M. on the _____ day of _____

County Recorder _____

By _____, Deputy

DOCUMENT NUMBER _____

[Handwritten Signature]

SIGNATURE

Aug 31, 2012

DATE

Registration No. 441880

- Land Surveyor County Surveyor
 Professional Engineer
 Chief Surveyor, City of St. Paul