

CERTIFICATE OF MONUMENT LOCATION

CITY MON. NO. 20

OLD INDEX NO. 1872

1/4 Corner in the NE Qtr. of Section 23 Township 29 Range 22

STATE OF MINNESOTA, County of Ramsey

At the corner location shown on the sketch:

On APRIL 7, 2014 found a CLIM E RUTH ST. E. DRIVE LAWE

date

LARPENTEUR AVE .15 BELOW ASPHALT GRADE

- left monument as found lowered monument removed monument (explain)

On APRIL 7, 2014 placed FIELD TIES . PHOTOS

date

SKETCH OF REFERENCE TIES

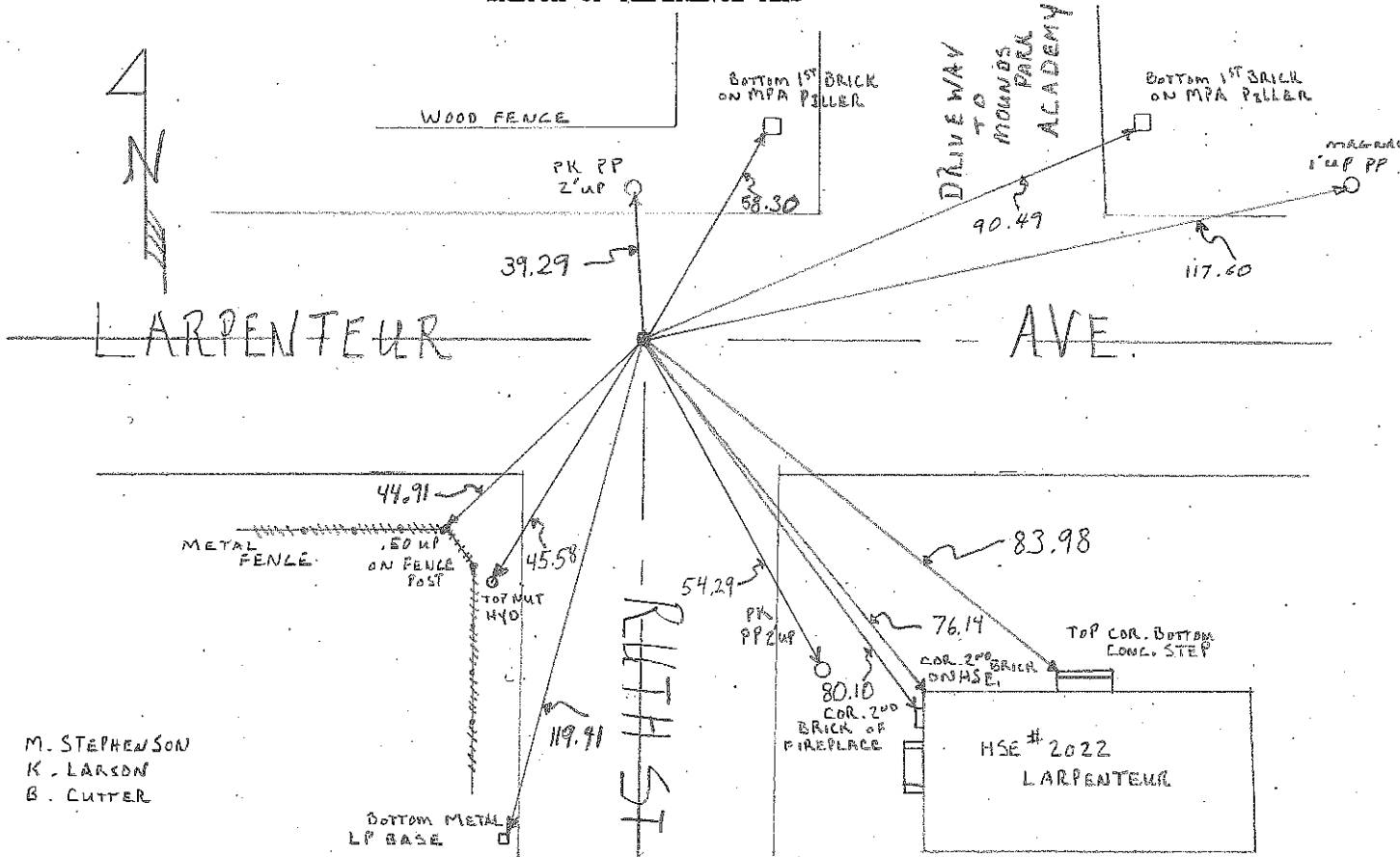

Statement of evidence relative to this corner is available from the St. Paul Public Works Dept., Survey Division

I hereby certify that this document and the data contained herein was prepared by me or under my direct supervision.

[Signature] MAY 21, 2015
SIGNATURE DATE

Registration No. 44880

- Land Surveyor County Surveyor
 Professional Engineer
 Chief Surveyor, City of St. Paul

Office of The County Recorder, County of Ramsey

I hereby certify that this document was filed in the county
Recorders office at _____ M. on the _____ day of _____

County Recorder _____

By _____, Deputy

DOCUMENT NUMBER _____

5/21/15 AA