

CERTIFICATE OF LOCATION OF GOVERNMENT CORNER

CITY MON. NO. 3

OLD INDEX NO. 1504

NE Corner of Section 20 Township 29 Range 23, P.M.

STATE OF MINNESOTA, County of Ramsey

At the corner location shown on the sketch:

On 11-30-09 found a CIM, under cover 1.0' below
date
Concrete Pavement. (set SE EDM Ties)

left monument as found lowered monument removed monument (explain)

On 11-30-09 placed a New Ties
date CREW DN, KL

SKETCH OF REFERENCE TIES

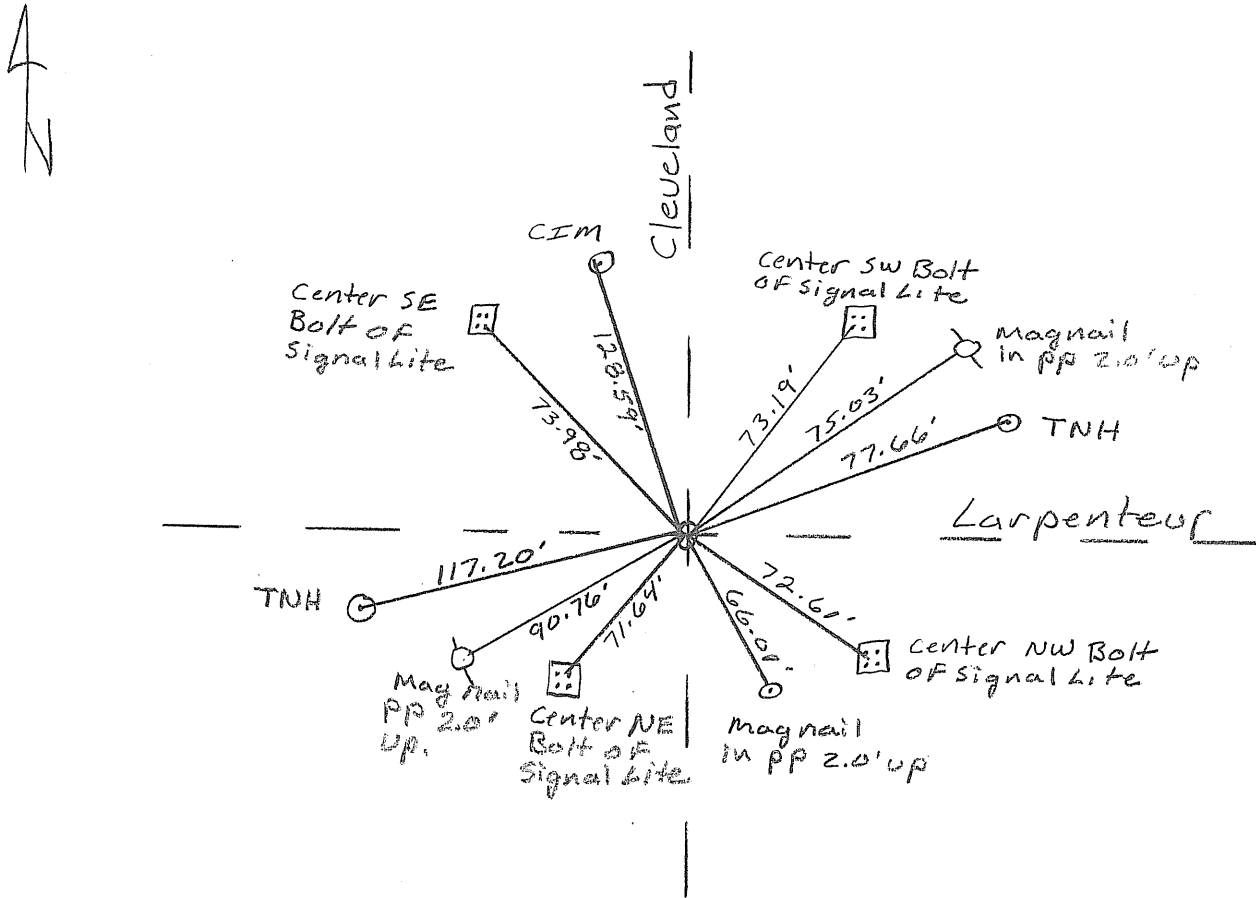

Statement of evidence relative to this corner is available from the St. Paul Public Works Dept., Survey Division

I hereby certify that this document and the data contained herein was prepared by me or under my direct supervision.

[Signature] Feb 3, 2010
SIGNATURE DATE

Registration No. 44880

Land Surveyor County Surveyor

Professional Engineer

Chief Surveyor, City of St. Paul

Office of The County Recorder, County of Ramsey

I hereby certify that this document was filed in the county
 Recorders office at M. on the day of

County Recorder

By , Deputy

DOCUMENT NUMBER