

18-29-22  
12

18-29-22

COUNTY ASSESSOR'S OFFICE AREAS & DIMENSIONS SUBJECT TO CHANGE

13

17

19

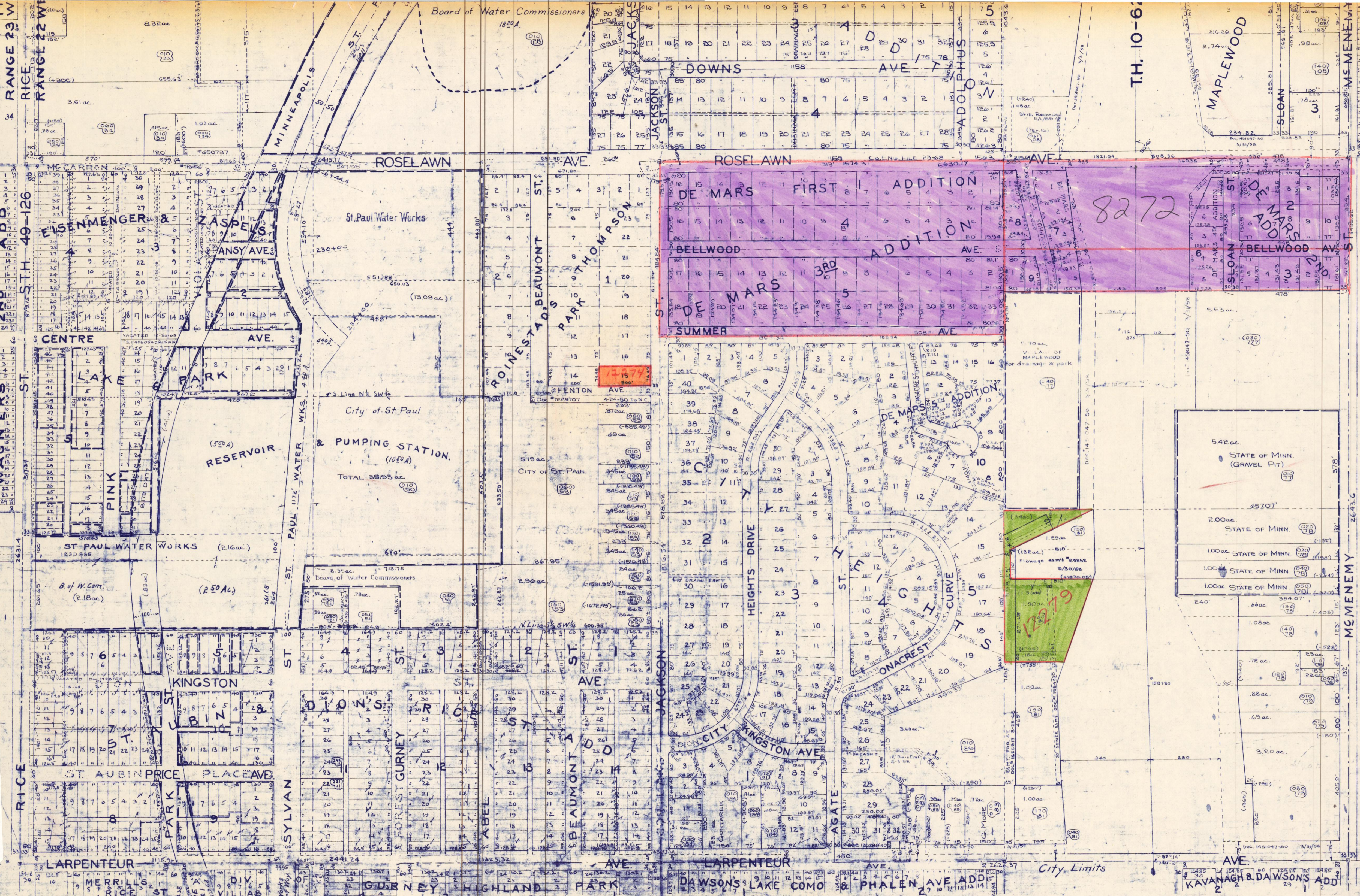

RANGE 23 W  
RICE  
RANGE 22 W

WAGNERS ST.  
ST. H. 49-126

WAGNERS ST.  
ST. H. 49-126

WAGNERS ST.  
ST. H. 49-126

WAGNERS ST.  
ST. H. 49-126

TH. 10-62

MAPLEWOOD  
SLOAN

MCMENEMY  
MAGOFFINS

STATE OF MINN. (GRAVEL PIT)  
542ac  
200ac  
100ac  
100ac  
100ac

City Limits  
KAVANAGH & DAWSONS ADD

LAST COR. 8-18-72 EHA