

N.W. 1/4 Sec. 36-29, 23.

G R E A T N O R T H E R N R Y.

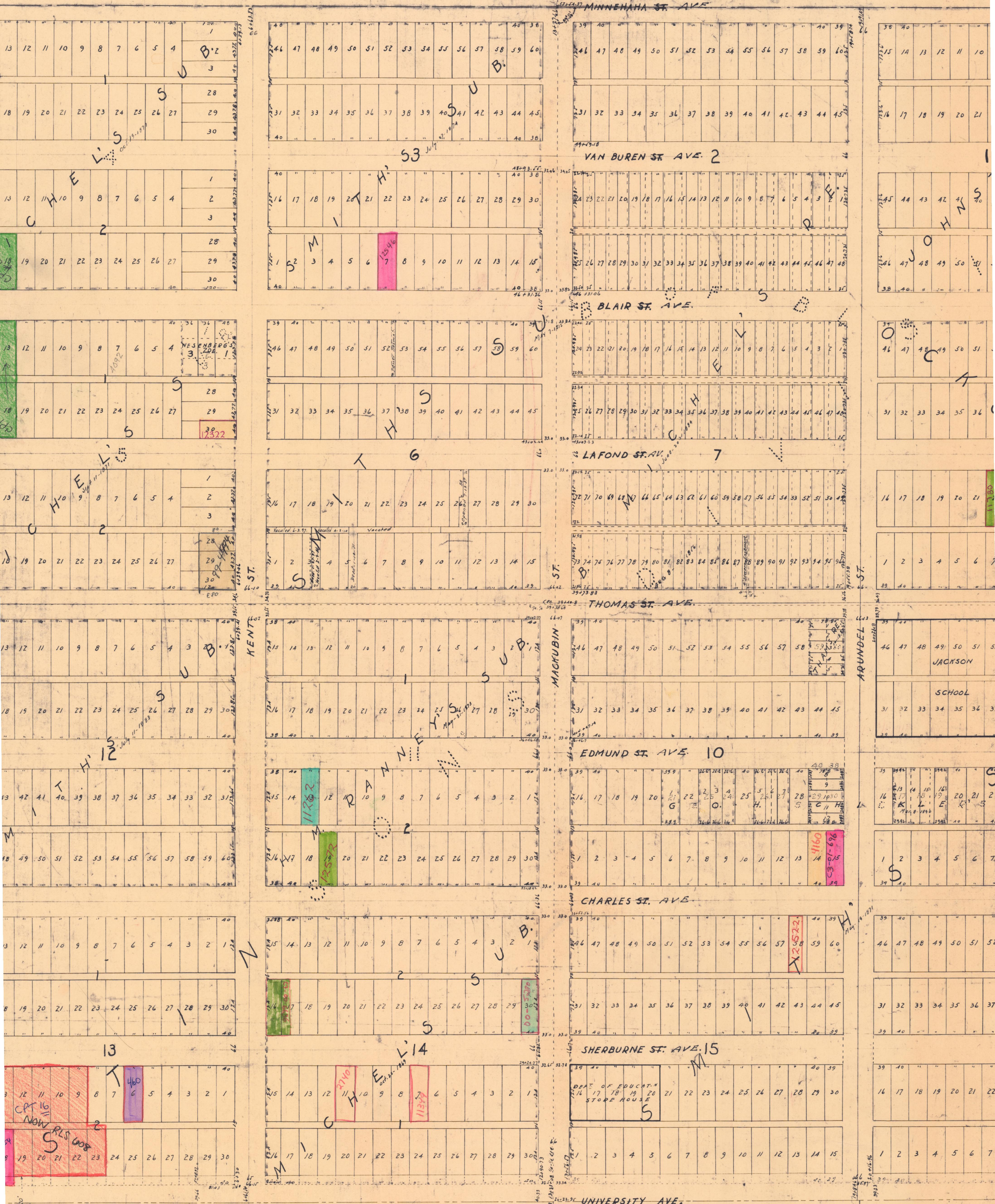

MINNEHAHA ST. AVE.

VAN BUREN ST. AVE. 2

BLAIR ST. AVE.

LAFOND ST. AVE. 7

THOMAS ST. AVE.

EDMUND ST. AVE. 10

CHARLES ST. AVE.

SHERBURNE ST. AVE. 15

UNIVERSITY AVE.

KENT ST.

MACHUBIN ST.

ARUNDEL ST.

C K ' S A D D.

M A C K U B I N

M A R S H A L L ' S