

8194 &
Inp 36" 148' Conc.

Root

PLAN
NOTED BY: HARRY S. BRONSON
DATE: 4-10-40

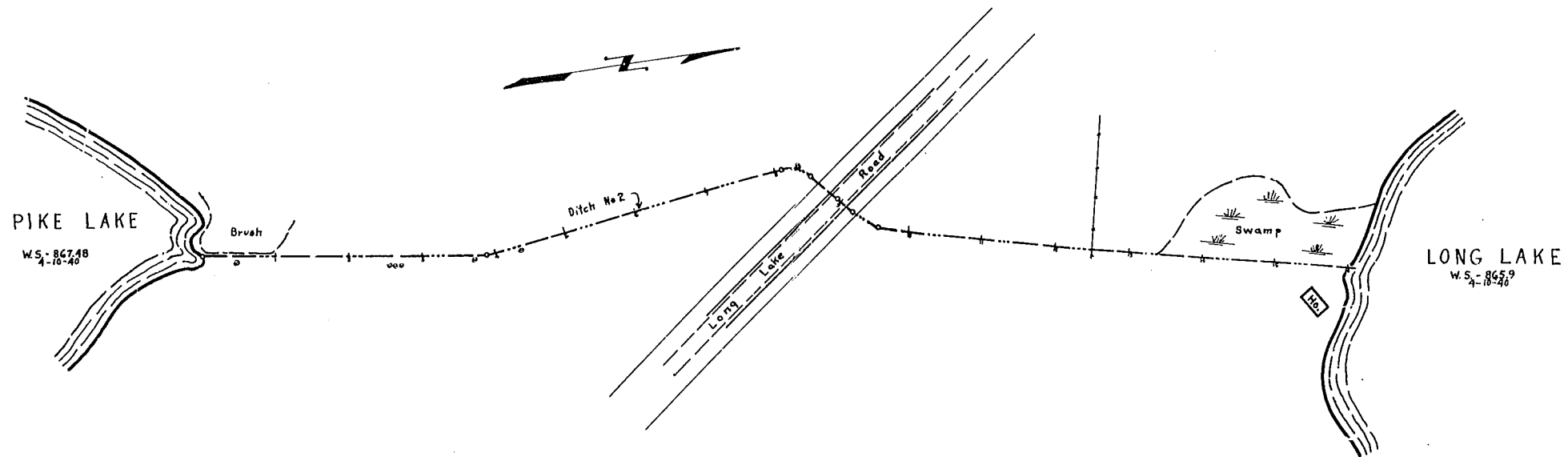

PROFILE
NOTED BY: HARRY S. BRONSON
DATE: 4-10-40

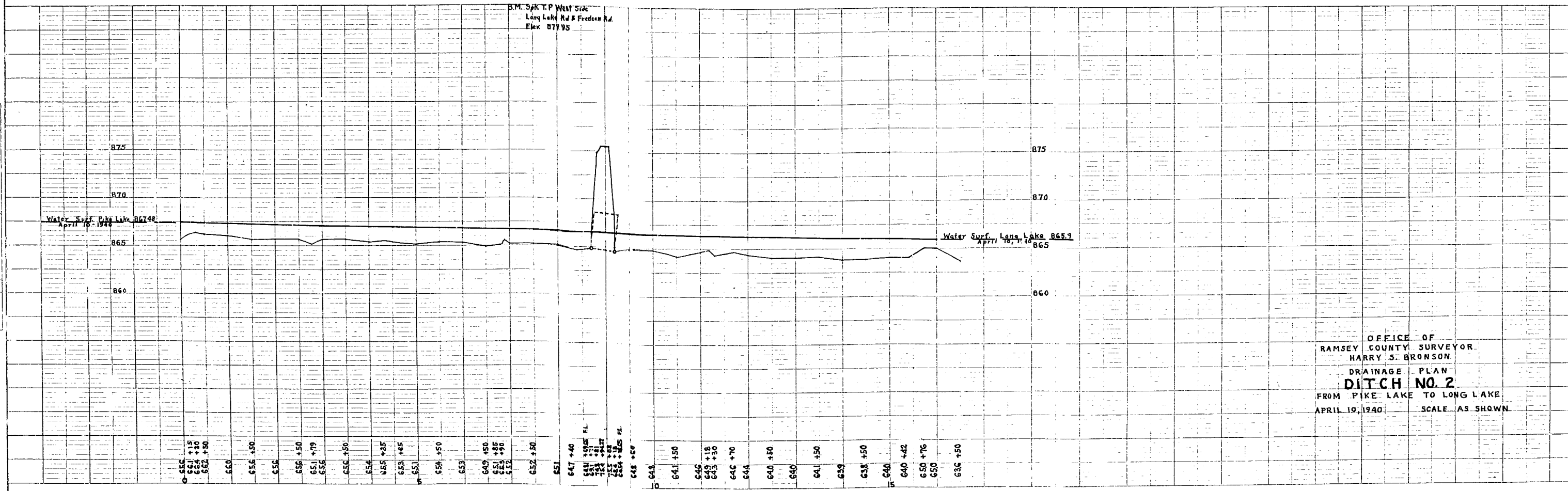

OFFICE OF
RAMSEY COUNTY SURVEYOR
HARRY S. BRONSON
DRAINAGE PLAN
DITCH NO. 2
FROM PIKE LAKE TO LONG LAKE
APRIL 10, 1940 SCALE AS SHOWN