

Ramsey County Minnesota Parcel Map

N Half
Section 17
T 28 N
R 23 W

Ramsey County
Section 8

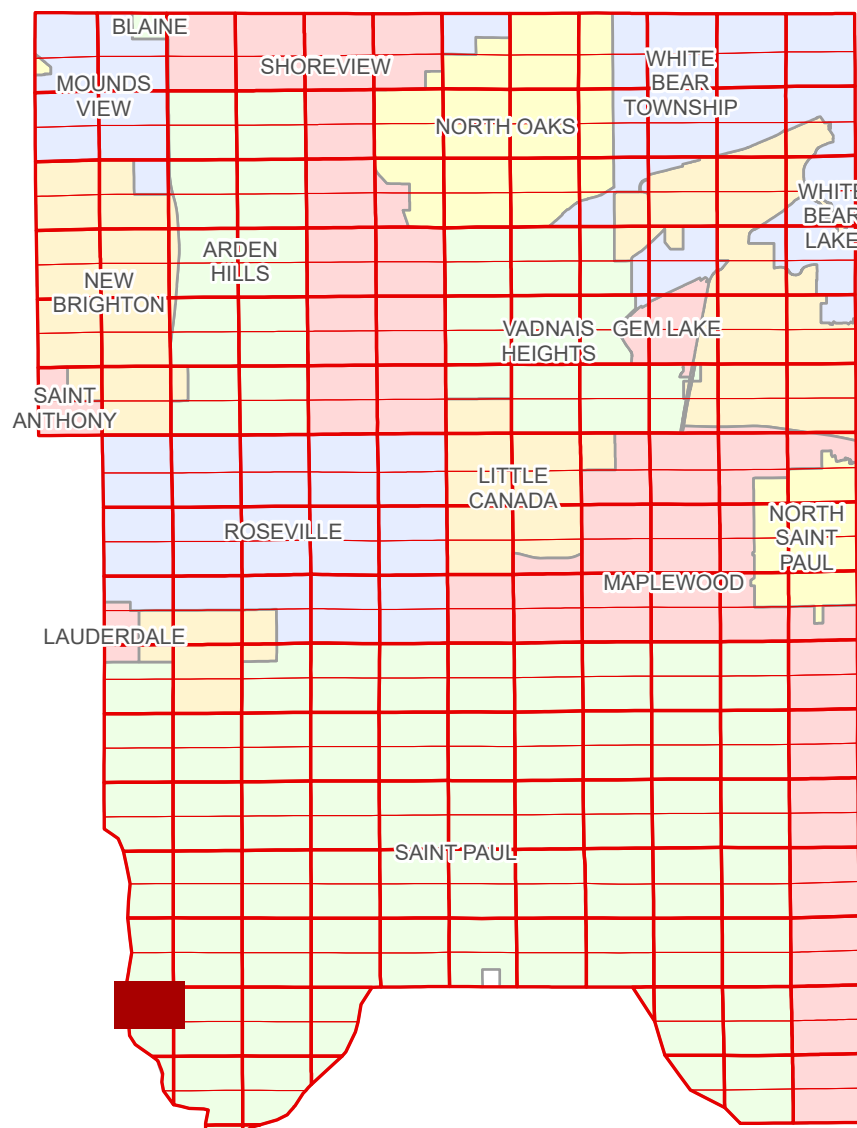

Hennepin County
Section 17

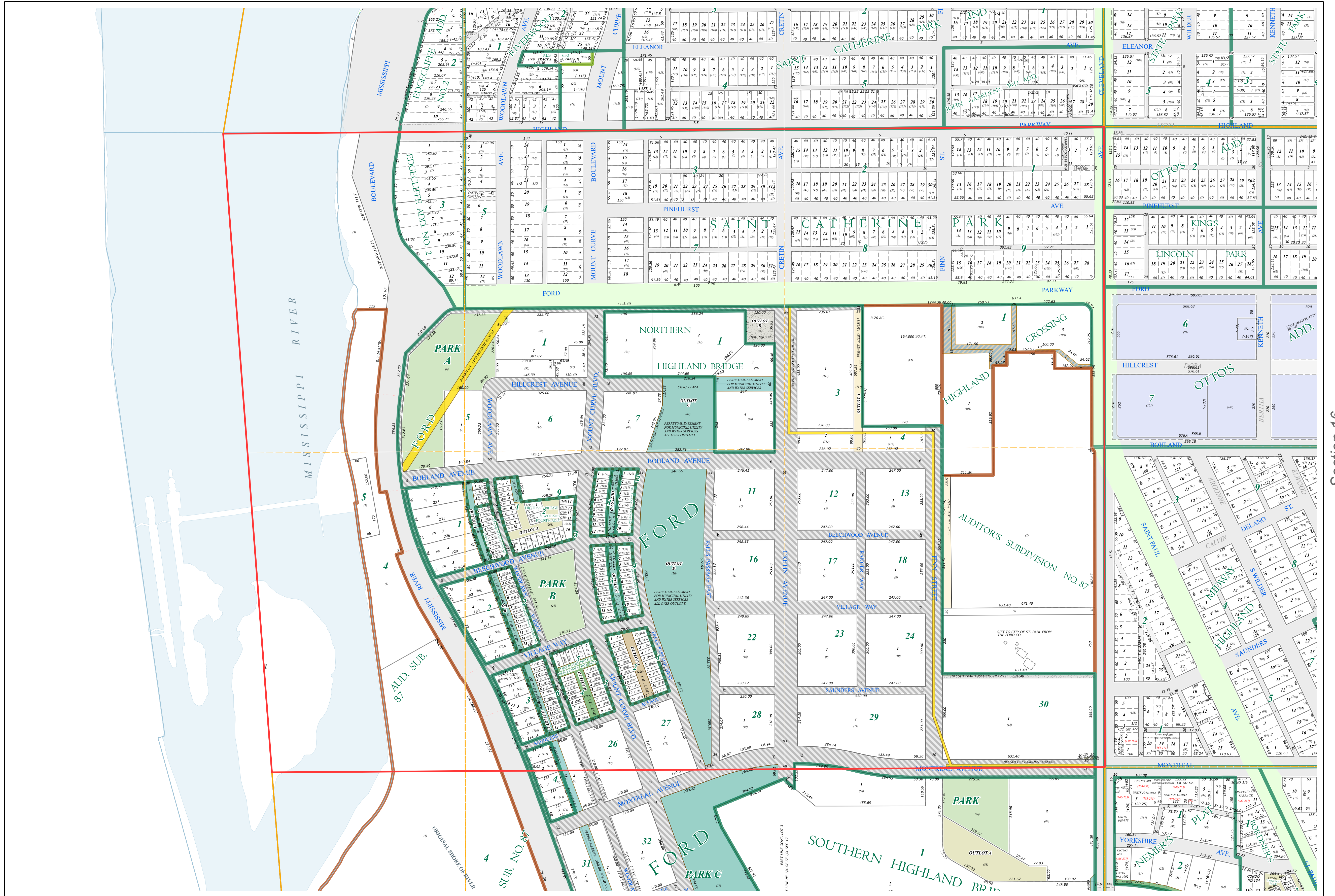

Section 16
Ramsey County

Legend

Section	Tax Parcel Type
Quarter	Personal Property
Quarter Quarter	Real Property
County Right of Way	Easement Type
Municipal Right of Way	Pedestrian
Subdivision Type	Private Access
Subdivision Plat	Public Right of Way
Auditors's Subdivision	Utility, Gas & Oil
Planned Community	Utility, Storm & Sanitary Sewer
Division Type	Utility, Water
Lot	Utility, Unidentified
Outlot	Drainage & Utility
Park	Misc Easements
Metes & Bounds	

The information on this map is a compilation of Ramsey County Records. THE COUNTY DOES NOT WARRANT OR GUARANTEE THE ACCURACY OF THIS DATA. The County disclaims any liability for any injuries, time delays, or expenses you may suffer if you rely in any manner on the accuracy of this data.

Produced by Information Services Enterprise GIS Division
RCGISMetaData@Co.Ramsey.MN.US

NOTE: This is not an official Ramsey County tax lot map. This is based on the data available in the Geographic Information System, which may vary from tax data officially recorded in the Tax System. For an official tax map, please contact the Office of Property Records and Revenue.

651-266-2000
AskPropertyTaxandRecords@co.ramsey.mn.us

Section 17
Ramsey County

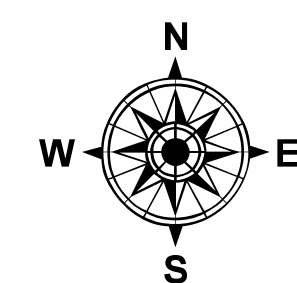

0 4590 180 270 360 Feet

1" = 200'
1:2,400

N172823

1/3/2025